

BB02-HF

CUSTOMER PRODUCT SPECIFICATION SHEET

RoHS
Compliant

BB02-HF:- 2.54mm x 2.54mm (0.1" x 0.1") BOX HEADER, 4 WALL SHROUDED DUAL ROW, STRAIGHT, 6 TO 64 CONTACTS

SPECIFICATIONS

CURRENT RATING	3 AMP
INSULATOR RESISTANCE	1000 MEGOHMS MIN.
DIELECTRIC WITHSTANDING	AC 600 V
OPERATING TEMPERATURE	-40°C TO 105°C
CONTACT MATERIAL	BRASS
INSULATOR MATERIAL	THERMOPLASTIC, UL 94V-0
	NYLON 6T : STANDARD
	PBT : SPECIAL OPTION
PLATING	GOLD, TIN OR SELECTIVE OVER 30-50U" NICKEL
SOLDERABILITY: NYLON 6T - IR REFLOW: 260°C FOR 10 SEC	
	WAVE: 230°C FOR 5-10 SEC
	MANNUAL SOLDER: 350°C FOR 3-5 SEC
PBT - MANNUAL SOLDER: 330°C FOR 3-5 SEC	
(NOT SUITABLE FOR HI-TEMP PROCESS)	

PACKED IN TRAYS Δ

MATES WITH: - BB02-KA BB02-KS
BB02-KD BB02-KT
BB02-KF BB02-KU
BB02-KG BB02-KW
BB02-KH BB02-LD
BB02-KK
BB02-KM

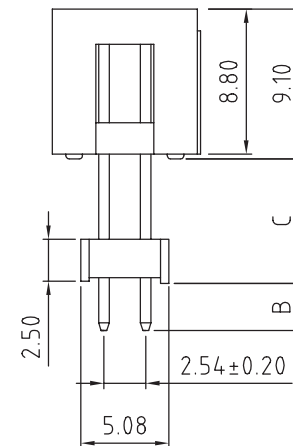
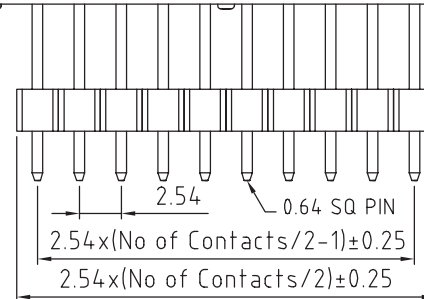
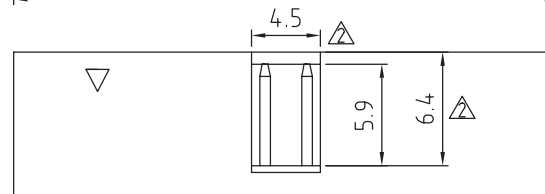
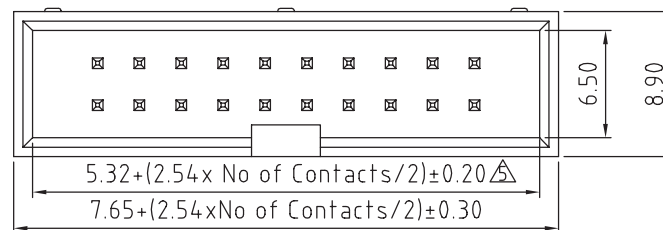

HOW TO ORDER

BB02 - HFXX1 - X01 - XXXXX - 6T

Δ NO. OF CONTACTS
06, 08, 10, 12, 14
16, 20, 24, 26, 30
34, 40, 44, 50, 60
64

CONTACT PLATING OPTIONS
K = GOLD FLASH (STANDARD)
A = 10U" GOLD ON CONTACT/GOLD FLASH ON TAIL
B = 15U" GOLD ON CONTACT/GOLD FLASH ON TAIL
C = 30U" GOLD ON CONTACT/GOLD FLASH ON TAIL
T = BRIGHT TIN
M = MATT TIN
D = GOLD FLASH ON CONTACT/BRIGHT TIN ON TAIL
E = 10U" GOLD ON CONTACT/BRIGHT TIN ON TAIL
F = 15U" GOLD ON CONTACT/BRIGHT TIN ON TAIL
G = 30U" GOLD ON CONTACT/BRIGHT TIN ON TAIL

PIN LENGTH C (1/10mm)
PLEASE SPECIFY PIN
LENGTH RERQUIRED
I.E. 2.5mm = 025
STANDARD = 075
MINIMUM = 025
MAXIMUM = 260
TOL.: ±0.25MM

PIN LENGTH B (1/10mm)
PLEASE SPECIFY PIN
LENGTH RERQUIRED
I.E. 2.5mm = 025
STANDARD = 030
TOL.: ±0.25MM

INSULATOR MATERIAL Δ
6T = NYLON 6T (STANDARD)
BLANK = PBT (Not suitable for
new designs.)

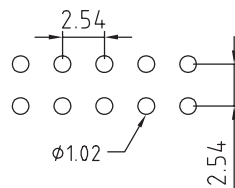

RECOMMENDED PCB LAYOUT
(TOLERANCE: ±0.05)

REV.	DATE & DRN
1.0	04/10/04 - CHC NEW
1.1	14/08/06 - NYW
1.2	29/06/07 - CHC
1.3	06/02/09 - CHC
1.4	27/05/09 - NYW
1.5	15/04/11 - NYW
1.6	15/04/11 - NYW
1.7	15/04/11 - NYW
1.8	15/04/11 - NYW
1.9	15/04/11 - NYW
2.0	15/04/11 - NYW
2.1	15/04/11 - NYW
2.2	15/04/11 - NYW
2.3	15/04/11 - NYW
2.4	15/04/11 - NYW
2.5	15/04/11 - NYW
2.6	15/04/11 - NYW
2.7	15/04/11 - NYW
2.8	15/04/11 - NYW
2.9	15/04/11 - NYW
3.0	15/04/11 - NYW
3.1	15/04/11 - NYW
3.2	15/04/11 - NYW
3.3	15/04/11 - NYW
3.4	15/04/11 - NYW
3.5	15/04/11 - NYW
3.6	15/04/11 - NYW
3.7	15/04/11 - NYW
3.8	15/04/11 - NYW
3.9	15/04/11 - NYW
4.0	15/04/11 - NYW
4.1	15/04/11 - NYW
4.2	15/04/11 - NYW
4.3	15/04/11 - NYW
4.4	15/04/11 - NYW
4.5	15/04/11 - NYW
4.6	15/04/11 - NYW
4.7	15/04/11 - NYW
4.8	15/04/11 - NYW
4.9	15/04/11 - NYW
5.0	15/04/11 - NYW
5.1	15/04/11 - NYW
5.2	15/04/11 - NYW
5.3	15/04/11 - NYW
5.4	15/04/11 - NYW
5.5	15/04/11 - NYW
5.6	15/04/11 - NYW
5.7	15/04/11 - NYW
5.8	15/04/11 - NYW
5.9	15/04/11 - NYW
6.0	15/04/11 - NYW
6.1	15/04/11 - NYW
6.2	15/04/11 - NYW
6.3	15/04/11 - NYW
6.4	15/04/11 - NYW
6.5	15/04/11 - NYW
6.6	15/04/11 - NYW
6.7	15/04/11 - NYW
6.8	15/04/11 - NYW
6.9	15/04/11 - NYW
7.0	15/04/11 - NYW
7.1	15/04/11 - NYW
7.2	15/04/11 - NYW
7.3	15/04/11 - NYW
7.4	15/04/11 - NYW
7.5	15/04/11 - NYW
7.6	15/04/11 - NYW
7.7	15/04/11 - NYW
7.8	15/04/11 - NYW
7.9	15/04/11 - NYW
8.0	15/04/11 - NYW
8.1	15/04/11 - NYW
8.2	15/04/11 - NYW
8.3	15/04/11 - NYW
8.4	15/04/11 - NYW
8.5	15/04/11 - NYW
8.6	15/04/11 - NYW
8.7	15/04/11 - NYW
8.8	15/04/11 - NYW
8.9	15/04/11 - NYW
9.0	15/04/11 - NYW
9.1	15/04/11 - NYW
9.2	15/04/11 - NYW
9.3	15/04/11 - NYW
9.4	15/04/11 - NYW
9.5	15/04/11 - NYW
9.6	15/04/11 - NYW
9.7	15/04/11 - NYW
9.8	15/04/11 - NYW
9.9	15/04/11 - NYW
10.0	15/04/11 - NYW

Scale: 3:1

Drawn: CHC

App'd: NYW

Date: 15 APR '11

THIRD ANGLE

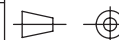

Title: BOX HEADER

Revision: 1.5

Unstated Tolerances:
X: ± 0.30
X: ± 0.25
XX: ± 0.15
XXX: ± 0.10

Material
SEE NOTE

NOT TO SCALE

Unit: mm



THIS DRAWING IS CONFIDENTIAL AND MUST NOT BE
COPIED OR DISCLOSED WITHOUT WRITTEN CONSENT

Type: BB02-HF

BB02-HF

Drawing Number:

Sheet 1 of 1

Drawing C

E and O E