

BB02-KF:- 2.54mm X 2.54mm (0.1" X 0.1") SOCKET, DUAL ROW, STRAIGHT, THROUGH HOLE - 04 TO 80 CONTACTS, LOW PROFILE

SPECIFICATIONS

CURRENT RATING	3 AMPS
INSULATOR RESISTANCE	1000 MEGOHMS MIN.
CONTACT RESISTANCE	20 m OHMS MAX
DIELECTRIC WITHSTANDING	AC 600 V
OPERATING TEMPERATURE	-40°C TO +105°C
CONTACT MATERIAL	PHOSPHOR BRONZE
INSULATOR MATERIAL	POLYESTER UL 94V-0
	NYLON 6T : STANDARD
	PBT : SPECIAL OPTION
PLATING	GOLD, TIN OR SELECTIVE OVER 30-50U" NICKEL
SOLDERABILITY:	NYLON 6T - IR REFLOW: 260°C FOR 10 SEC
	WAVE: 230°C FOR 5-10 SEC
	MANNUAL SOLDER: 350°C FOR 3-5 SEC
	PBT - MANNUAL SOLDER: 330°C FOR 3-5 SEC
	(NOT SUITABLE FOR HI-TEMP PROCESS)

NOTES:

1. PACKED IN TRAYS OR TUBE. \triangle_2
2. RECOMMENDED MATING PIN LENGTH: 4.5MM. \triangle_4

MATES WITH: BB02-HE BB02-HR BB02-TH
BB02-HF BB02-HU
BB02-HJ BB02-TD
BB02-HP BB02-TF
BB02-HQ BB02-TG

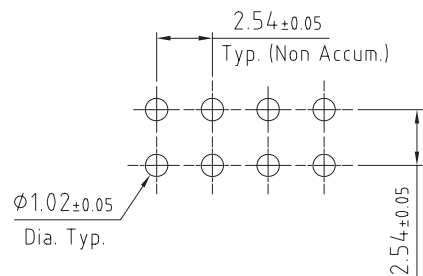

RECOMMENDED PC BOARD HOLE LAYOUT

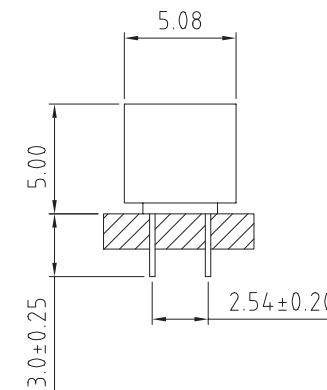
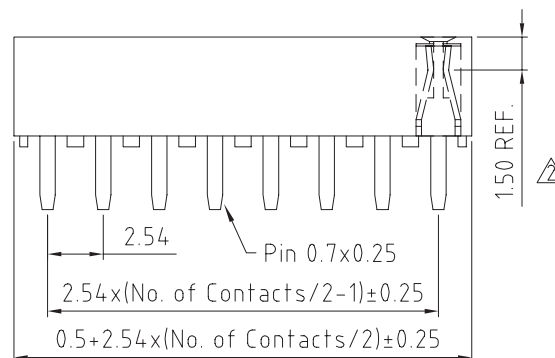
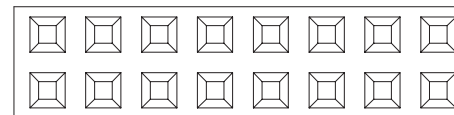

HOW TO ORDER

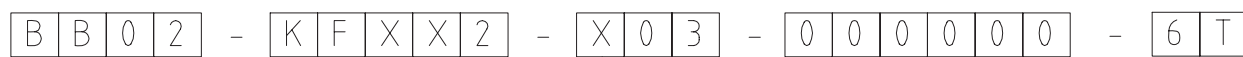

NO. OF CONTACTS
04 TO 80

1 CONTACT PLATING OPTIONS

K = GOLD FLASH (STANDARD)
A = 10U" GOLD ON CONTACT/GOLD FLASH ON TAIL
B = 15U" GOLD ON CONTACT/GOLD FLASH ON TAIL
C = 30U" GOLD ON CONTACT/GOLD FLASH ON TAIL
T = BRIGHT TIN
M = MATT TIN
D = GOLD FLASH ON CONTACT/BRIGHT TIN ON TAIL
E = 10U" GOLD ON CONTACT/BRIGHT TIN ON TAIL
F = 15U" GOLD ON CONTACT/BRIGHT TIN ON TAIL
G = 30U" GOLD ON CONTACT/BRIGHT TIN ON TAIL

INSULATOR MATERIAL 
6T = NYLON 6T (STANDARD)
BLANK = PBT (Not suitable for
new designs.)

[illegible]