

BB02-NH

## CUSTOMER PRODUCT SPECIFICATION SHEET

RoHS  
Compliant

BB02-NH - 1.27mm (0.05") PIN HEADER, SINGLE ROW, RIGHT ANGLE, THROUGH HOLE TYPE 02 to 50 CONTACTS

## SPECIFICATIONS

CURRENT RATING	1 AMP
INSULATOR RESISTANCE	1000 MEGOHMS MIN
CONTACT RESISTANCE	20 MLLIOHMS MAX
DIELECTRIC WITHSTANDING	AC 300V
OPERATING TEMPERATURE	-40°C TO +105°C
CONTACT MATERIAL	BRASS
INSULATOR MATERIAL	THERMO PLASTIC, UL 94V-0
	STANDARD: LCP
PLATING	GOLD, TIN OR SELECTIVE OVER 30-50U" NICKEL
SOLDERABILITY	IR REFLOW: 280°C FOR 10 SEC
	WAVE: 250°C FOR 5-10 SEC
	MANUAL SOLDER: 380°C FOR 3-5 SE

PACKED LOOSE IN BOX.

MATES WITH: - BB02-CE BB02-NP  
BB02-CF  
BB02-NU

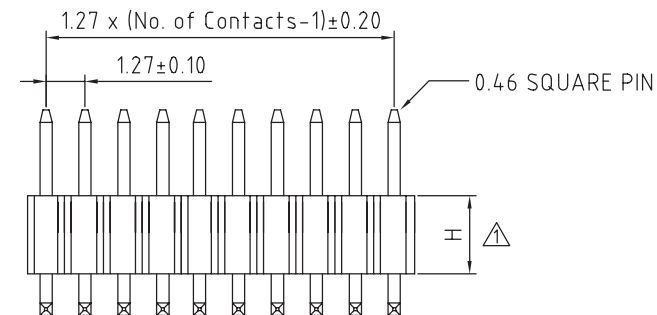
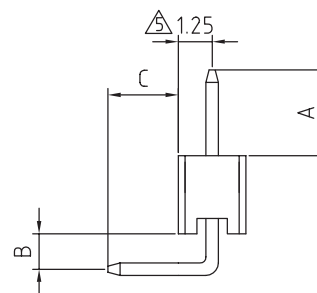
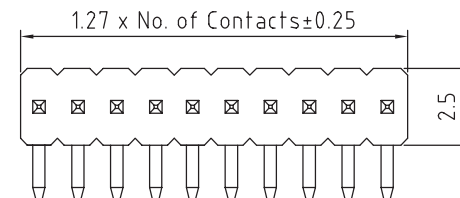

## HOW TO ORDER

BB02 - NHXX1 - XX1 - XXXXX

NO OF CONTACTS  
02 TO 50

## CONTACT PLATING OPTIONS

K = GOLD FLASH (STANDARD)  
A = 10U" GOLD ON CONTACT/GOLD FLASH ON TAIL  
B = 15U" GOLD ON CONTACT/GOLD FLASH ON TAIL  
C = 30U" GOLD ON CONTACT/GOLD FLASH ON TAIL  
T = BRIGHT TIN  
M = MATT TIN  
D = GOLD FLASH ON CONTACT/BRIGHT TIN ON TAIL  
E = 10U" GOLD ON CONTACT/BRIGHT TIN ON TAIL  
F = 15U" GOLD ON CONTACT/BRIGHT TIN ON TAIL  
G = 30U" GOLD ON CONTACT/BRIGHT TIN ON TAIL

HEIGHT "H"  $\Delta$   
0 = 2.54MM  
A = 1.7MM  
B = 1.4MM

DIMENSION A (1/10mm)  
PLEASE SPECIFY PIN  
LENGTH REQUIRED  
I.E. 2.5mm = 25  
STANDARD = 28  
TOL.  $\pm 0.25$ MM

DIMENSION B (1/10mm)  
PLEASE SPECIFY PIN  
LENGTH REQUIRED  
I.E. 2.5mm = 25  
STANDARD = 08  
TOL.  $\pm 0.25$ MM  
(MIN. 0.3mm)

DIMENSION C (1/10mm)  
PLEASE SPECIFY PIN  
LENGTH REQUIRED  
I.E. 2.5mm = 25  
STANDARD = 25  
TOL.  $\pm 0.25$ MM



RECOMMENDED PC BOARD LAYOUT  
(TOLERANCE:  $\pm 0.05$ )

REV.	DATE & DRN
1.0	29/6/06 - CHG. RELEASE
1.1	09/06/06 - NYW
1.2	09/06/06 - NYW
1.3	09/06/06 - NYW
1.4	09/06/06 - NYW
1.5	09/06/06 - NYW
1.6	09/06/06 - NYW
1.7	09/06/06 - NYW
1.8	09/06/06 - NYW
1.9	09/06/06 - NYW
2.0	09/06/06 - NYW
2.1	09/06/06 - NYW
2.2	09/06/06 - NYW
2.3	09/06/06 - NYW
2.4	09/06/06 - NYW
2.5	09/06/06 - NYW
2.6	09/06/06 - NYW
2.7	09/06/06 - NYW
2.8	09/06/06 - NYW
2.9	09/06/06 - NYW
3.0	09/06/06 - NYW
3.1	09/06/06 - NYW
3.2	09/06/06 - NYW
3.3	09/06/06 - NYW
3.4	09/06/06 - NYW
3.5	09/06/06 - NYW
3.6	09/06/06 - NYW
3.7	09/06/06 - NYW
3.8	09/06/06 - NYW
3.9	09/06/06 - NYW
4.0	09/06/06 - NYW
4.1	09/06/06 - NYW
4.2	09/06/06 - NYW
4.3	09/06/06 - NYW
4.4	09/06/06 - NYW
4.5	09/06/06 - NYW
4.6	09/06/06 - NYW
4.7	09/06/06 - NYW
4.8	09/06/06 - NYW
4.9	09/06/06 - NYW
5.0	09/06/06 - NYW
5.1	09/06/06 - NYW
5.2	09/06/06 - NYW
5.3	09/06/06 - NYW
5.4	09/06/06 - NYW
5.5	09/06/06 - NYW
5.6	09/06/06 - NYW
5.7	09/06/06 - NYW
5.8	09/06/06 - NYW
5.9	09/06/06 - NYW
6.0	09/06/06 - NYW
6.1	09/06/06 - NYW
6.2	09/06/06 - NYW
6.3	09/06/06 - NYW
6.4	09/06/06 - NYW
6.5	09/06/06 - NYW
6.6	09/06/06 - NYW
6.7	09/06/06 - NYW
6.8	09/06/06 - NYW
6.9	09/06/06 - NYW
7.0	09/06/06 - NYW
7.1	09/06/06 - NYW
7.2	09/06/06 - NYW
7.3	09/06/06 - NYW
7.4	09/06/06 - NYW
7.5	09/06/06 - NYW
7.6	09/06/06 - NYW
7.7	09/06/06 - NYW
7.8	09/06/06 - NYW
7.9	09/06/06 - NYW
8.0	09/06/06 - NYW
8.1	09/06/06 - NYW
8.2	09/06/06 - NYW
8.3	09/06/06 - NYW
8.4	09/06/06 - NYW
8.5	09/06/06 - NYW
8.6	09/06/06 - NYW
8.7	09/06/06 - NYW
8.8	09/06/06 - NYW
8.9	09/06/06 - NYW
9.0	09/06/06 - NYW
9.1	09/06/06 - NYW
9.2	09/06/06 - NYW
9.3	09/06/06 - NYW
9.4	09/06/06 - NYW
9.5	09/06/06 - NYW
9.6	09/06/06 - NYW
9.7	09/06/06 - NYW
9.8	09/06/06 - NYW
9.9	09/06/06 - NYW
10.0	09/06/06 - NYW

Scale 5=1

Drawn CHC

App'd NYW

Date 25 APR '11

THIRD ANGLE

Title PIN HEADER

Revision: 1.5

Unstated Tolerances  
X.  $\pm 0.30$   
.X  $\pm 0.25$   
.XX  $\pm 0.15$   
.XXX  $\pm 0.10$

Material  
SEE NOTE

NOT TO SCALE

Unit: mm



THIS DRAWING IS CONFIDENTIAL AND MUST NOT BE  
COPIED OR DISCLOSED WITHOUT WRITTEN CONSENT

Type BB02-NH

BB02-NH

Drawing Number

Sheet 1 of 1

Drawing (C) E and O E