

BB02-RJ

## CUSTOMER PRODUCT SPECIFICATION SHEET

RoHS  
Compliant

BB02-RJ :- 2.00mm x 2.00mm (0.079" x 0.079") SMD SOCKET, DUAL ROW, STRAIGHT - 04 TO 80 CONTACTS, TOP ENTRY

## SPECIFICATIONS

CURRENT RATING	2 AMP
INSULATOR RESISTANCE	1000 MEGOHMS MIN.
DIELECTRIC WITHSTANDING	AC 500 V
CONTACT RESISTANCE	20m OHMS MAX.
OPERATING TEMPERATURE	-55°C TO +105°C
CONTACT MATERIAL	PHOSPHOR BRONZE
INSULATOR MATERIAL	THERMOPLASTIC, UL 94V-0 STANDARD NYLON 6T
PLATING	GOLD, TIN OR SELECTIVE OVER 30-50U" NICKEL
SOLDERABILITY	IR REFLOW: 260°C FOR 10 SEC MANUAL SOLDER: 350°C FOR 3-5 SEC

## NOTES:

1. RECOMMANED MATING PIN LENGTH: 4.0MM  $\Delta$ 

MATES WITH :-	BB02-FA	BB02-FS	BB02-RN
	BB02-FD	BB02-FU	
	BB02-FE	BB02-FW	
	BB02-FG	BB02-FY	
	BB02-FP	BB02-FZ	
	BB02-FQ	BB02-RH	

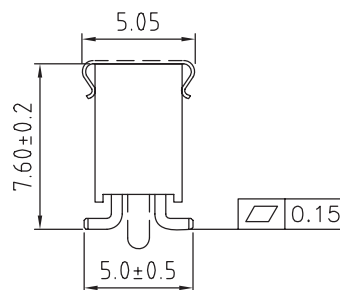
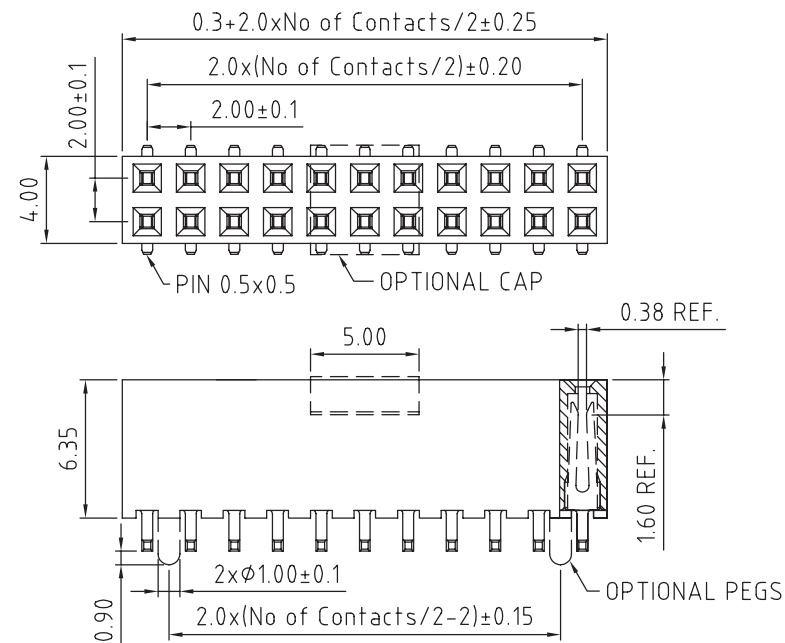

## HOW TO ORDER

B B 0 2 - R J X X 2 - X 0 X - X 0 0 0 0 0

NO. OF CONTACTS  
04 TO 80

## CONTACT PLATING OPTIONS

K = GOLD FLASH (STANDARD)  
A = 10U" GOLD ON CONTACT/GOLD FLASH ON TAIL  
B = 15U" GOLD ON CONTACT/GOLD FLASH ON TAIL  
C = 30U" GOLD ON CONTACT/GOLD FLASH ON TAIL  
T = BRIGHT TIN  
M = MATT TIN  
D = GOLD FLASH ON CONTACT/BRIGHT TIN ON TAIL  
E = 10U" GOLD ON CONTACT/BRIGHT TIN ON TAIL  
F = 15U" GOLD ON CONTACT/BRIGHT TIN ON TAIL  
G = 30U" GOLD ON CONTACT/BRIGHT TIN ON TAIL

## PACKAGING OPTIONS

3 - TUBE  
5 - TUBE & CAP  
6 - T & R  
8 - T & R & CAP

WITH OR WITHOUT  
LOCATING PEG

A = WITH  
B = WITHOUT

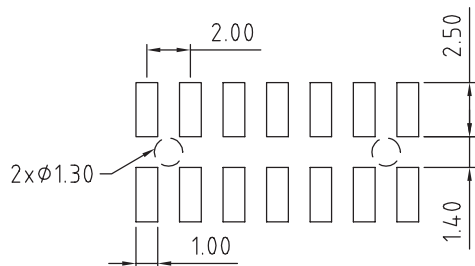

RECOMMENDED PC BOARD LAYOUT

REV.	DATE & DRN
1.0	25/08/06 - NYW RELEASE
1.1	29/05/07 - CHC
1.2	06/06/08 - CHC
1.3	07/08/08 - CHC
1.4	31/12/08 - NYW
	ADD NOTES 1.
	PLATING MODIFICATION.
	DRAWING MODIFICATION.
	DRAWING MODIFICATION.

Scale:	4:1	THIRD ANGLE	Unstated Tolerances:	Material
Drawn:	CHC		X. ± 0.30 .X ± 0.25 .XX ± 0.15 .XXX ± 0.10	SEE NOTE
App'd:	XXXX	Title	PIN HEADER	NOT TO SCALE
Date:	31 DEC '08	Revision:	1.4	Unit: mm

© THIS DRAWING IS CONFIDENTIAL AND MUST NOT BE  
COPIED OR DISCLOSED WITHOUT WRITTEN CONSENT

Type: BB02-RJ

BB02-RJ

Drawing Number:

Sheet 1 of 1

Drawing © E and O E