

BB02-RW

## CUSTOMER PRODUCT SPECIFICATION SHEET

RoHS  
Compliant

BB02-RW :- 2.00mm ( 0.079" ) SOCKET, RIGHT ANGLE, SMT, SINGLE ROW - 02 to 40 CONTACTS

## SPECIFICATIONS

CURRENT RATING	2 AMP
INSULATOR RESISTANCE	1000 MEGOHMS MIN.
DIELECTRIC WITHSTANDING	AC 500 V
CONTACT RESISTANCE	20 m OHMS MAX.
OPERATING TEMPERATURE	-55°C TO +105°C
CONTACT MATERIAL	PHOSPHOR BRONZE
INSULATOR MATERIAL	THERMOPLASTIC, UL94V-0
	STANDARD LCP
PLATING	GOLD, TIN OR SELECTIVE OVER 30~50U" NICKEL
SOLDERABILITY	IR REFLOW: 280°C FOR 10 SEC
	MANUAL SOLDER: 350°C FOR 3-5 SEC

## NOTES:

1. RECOMMENDED MATING PIN LENGTH: 3.2MM.

MATES WITH:- BB02-FB  
BB02-FK  
BB02-FL  
BB02-RM  
BB02-RT

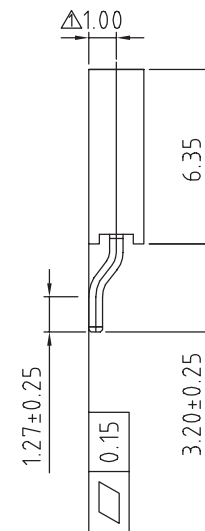
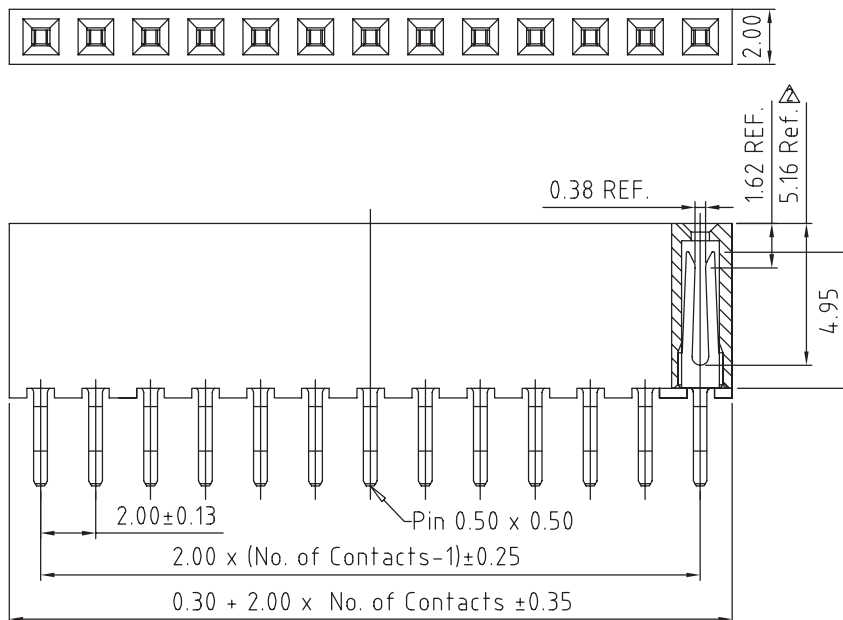

## HOW TO ORDER

B B 0 2 - R W X X 2 - X 0 X - 0 0 0 0 0 0

NO. OF CONTACTS  
02 TO 40

## CONTACT PLATING OPTIONS

K = GOLD FLASH (STANDARD)  
A = 10U" GOLD ON CONTACT/GOLD FLASH ON TAIL  
B = 15U" GOLD ON CONTACT/GOLD FLASH ON TAIL  
C = 30U" GOLD ON CONTACT/GOLD FLASH ON TAIL  
T = BRIGHT TIN  
M = MATT TIN  
D = GOLD FLASH ON CONTACT/BRIGHT TIN ON TAIL  
E = 10U" GOLD ON CONTACT/BRIGHT TIN ON TAIL  
F = 15U" GOLD ON CONTACT/BRIGHT TIN ON TAIL  
G = 30U" GOLD ON CONTACT/BRIGHT TIN ON TAIL

## PACKAGING OPTIONS

3 - TUBE  
6 - T & R  
STANDARD = 3

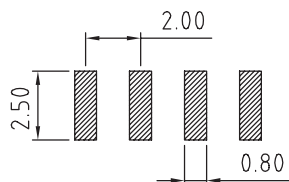

RECOMMENDED PCB LAYOUT  
(TOLERANCE: ±0.05)

REV.	DATE & DRN
10	11/10/10 - CHC RELEASE
11	25/04/11 - NYW
11	05/09/11 - NYW
11	05/09/11 - NYW

Scale: 5:1	THIRD ANGLE	Unstated Tolerances: X. ± 0.30 .X ± 0.25 .XX ± 0.15 .XXX ± 0.10	Material SEE NOTE
Drawn: CHC			
App'd: NYW	Title SOCKET		NOT TO SCALE
Date: 05 SEP '11	Revision: 1.2	Unit: mm	



THIS DRAWING IS CONFIDENTIAL AND MUST NOT BE  
COPIED OR DISCLOSED WITHOUT WRITTEN CONSENT

Type: BB02-RW

BB02-RW

Drawing Number:

Sheet 1 of 1

Drawing © E and O E