



Sullins Edgecards

.050" [1.27mm] Contact Centers, .610" Insulator Height
Dip Solder/Card Extender/SMT

SPECIFICATIONS

- Accommodates $.062" \pm .008" [1.57 \pm .20]$ PC board
- PPS or PA9T insulator
- Molded-in key available
- High reliability/high cycle hairpin bellows contact
- 1 amp current rating per contact
- 150 grams normal force minimum

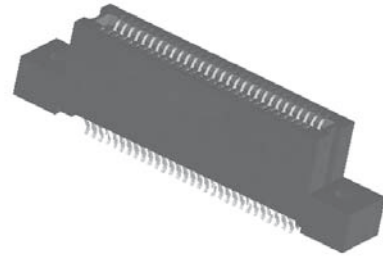

TERMINATION TYPE

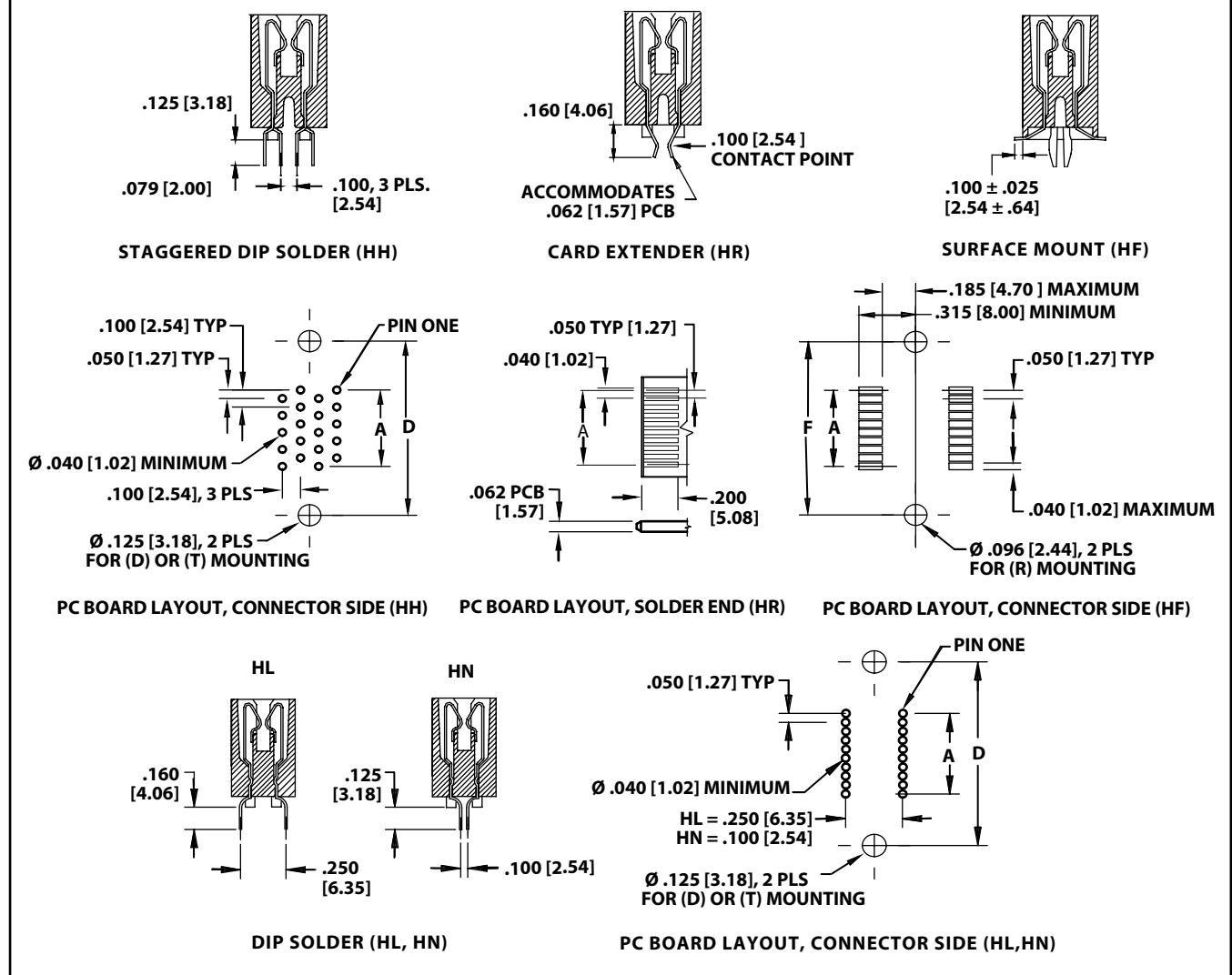

MOUNTING STYLE

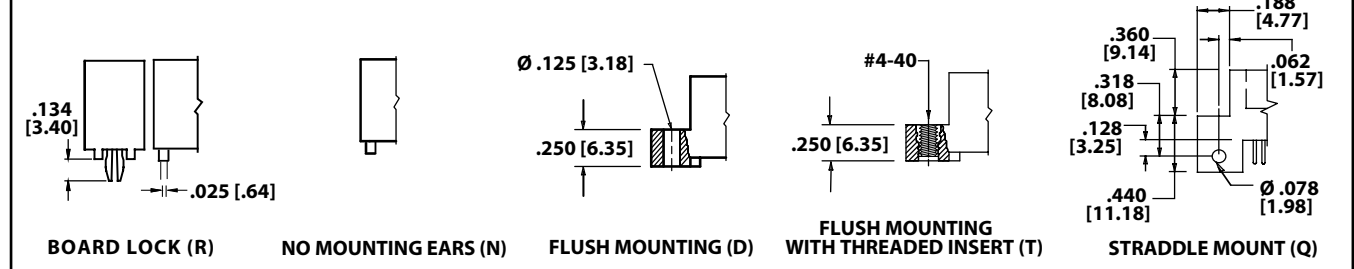



.050" [1.27mm] Contact Centers, .610" Insulator Height Dip Solder/Card Extender/SMT

PART NUMBER CODING

G B B 40 D HH D - Sxxx

MATERIALS (INSULATOR/CONTACT)
 G = PA9T/Phosphor Bronze
 R = PPS/Phosphor Bronze
 J = PA9T/Beryllium Copper
 A = PPS/Beryllium Copper
 (Consult Factory for Other Materials)

CONTACT FINISH - RoHS Compliant
All platings are Lead Free and have .000050" Nickel underplate
Contact Surface Termination
 B = .000010" Gold .000100" Pure Tin, Matte
 C = .000030" Gold .000100" Pure Tin, Matte

CONTACT CENTERS
 B = .050 [1.27mm]

NUMBER OF CONTACT POSITIONS
 See Chart Below

MODIFICATION CODE (Consult Factory)
 OMIT FOR STANDARD

MOUNTING STYLE (Opposite Page)
 D = Flush Mounting
 N = No Mounting
 T = Flush Mounting With Threaded Insert
 Q = Straddle Mount (Card Extender Only)
 R = Metal Boardlocks

TERMINATION TYPE (Opposite Page)
 HH = Staggered Dip Solder
 HR = Card Extender
 HF = Surface Mount
 HL = .250 x .160 [6.35mm x 4.06] Dip Solder
 HN = .100 x .125 [2.54mm x 3.18] Dip Solder
 (Replaces Terminations CH, CR, CF, CL, CN)

READOUT (Opposite Page)
 D = Dual

DIMENSIONS

Dimensions in [] are in millimeters, all others are in inches.

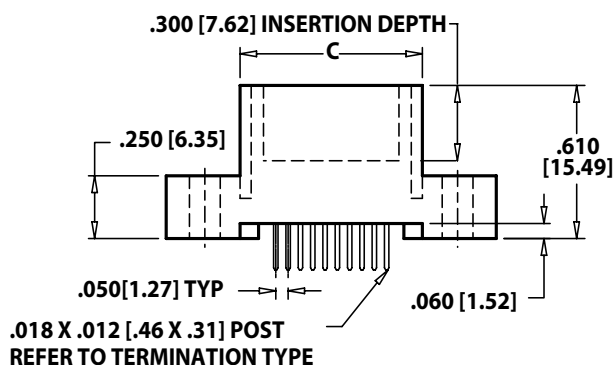
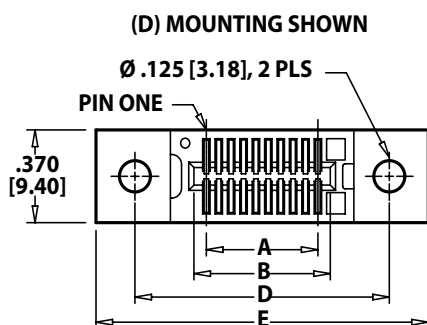

POSITIONS/ CONTACTS	INCHES						[MILLIMETERS]					
	A ±.005	B ±.005	C ±.015	D ±.010	E ±.020	F ±.010	A ±.13	B ±.13	C ±.38	D ±.25	E ±.51	F ±.25
05/10	0.200	0.300	0.490	0.776	1.090	0.350	5.08	7.62	12.45	19.71	27.69	8.89
06/12	0.250	0.350	0.540	0.826	1.140	0.400	6.35	8.89	13.72	20.98	28.96	10.16
09/18	0.400	0.500	0.690	0.976	1.290	0.550	10.16	12.70	17.53	24.79	32.77	13.97
10/20	0.450	0.550	0.740	1.026	1.340	0.600	11.43	13.97	18.80	26.06	34.04	15.24
13/26	0.600	0.700	0.890	1.176	1.490	0.750	15.24	17.78	22.61	29.87	37.85	19.05
14/28	0.650	0.750	0.940	1.226	1.540	0.800	16.51	19.05	23.88	31.14	39.12	20.32
15/30	0.700	0.800	0.990	1.276	1.590	0.850	17.78	20.32	25.15	32.41	40.39	21.59
20/40	0.950	1.050	1.240	1.526	1.840	1.100	24.13	26.67	31.50	38.76	46.74	27.94
22/44	1.050	1.150	1.340	1.626	1.940	1.200	26.67	29.21	34.04	41.30	49.28	30.48
24/48	1.150	1.250	1.440	1.726	2.040	1.300	29.21	31.75	36.58	43.84	51.82	33.02
25/50	1.200	1.300	1.490	1.776	2.090	1.350	30.48	33.02	37.85	45.11	53.09	34.29
30/60	1.450	1.550	1.740	2.026	2.340	1.600	36.83	39.37	44.20	51.46	59.44	40.64
34/68	1.650	1.750	1.940	2.226	2.540	1.800	41.91	44.45	49.28	56.54	64.52	45.72
35/70	1.700	1.800	1.990	2.276	2.590	1.850	43.18	45.72	50.55	57.81	65.79	46.99
40/80	1.950	2.050	2.240	2.526	2.840	2.100	49.53	52.07	56.90	64.16	72.14	53.34
45/90	2.200	2.300	2.490	2.776	3.090	2.350	55.88	58.42	63.25	70.51	78.49	59.69
50/100	2.450	2.550	2.740	3.026	3.340	2.600	62.23	64.77	69.60	76.86	84.84	66.04
55/110	2.700	2.800	2.990	3.276	3.590	2.850	68.58	71.12	75.95	83.21	91.19	72.39
60/120	2.950	3.050	3.240	3.526	3.840	3.100	74.93	77.47	82.30	89.56	97.54	78.74
64/128	3.150	3.250	3.440	3.726	4.040	3.300	80.01	82.55	87.38	94.64	102.62	83.82
65/130	3.200	3.300	3.490	3.776	4.090	3.350	81.28	83.82	88.65	95.91	103.89	85.09
66/132	3.250	3.350	3.540	3.826	4.140	3.400	82.55	85.09	89.92	97.18	105.16	86.36
70/140	3.450	3.550	3.740	4.026	4.340	3.600	87.63	90.17	95.00	102.26	110.24	91.44
75/150	3.700	3.800	3.990	4.276	4.590	3.850	93.98	96.52	101.35	108.61	116.59	97.79
80/160	3.950	4.050	4.240	4.526	4.840	4.100	100.33	102.87	107.70	114.96	122.94	104.14
85/170	4.200	4.300	4.490	4.776	5.090	4.350	106.68	109.22	114.05	121.31	129.29	110.49
90/180	4.450	4.550	4.740	5.026	5.340	4.600	113.03	115.57	120.40	127.66	135.64	116.84
95/190	4.700	4.800	4.990	5.276	5.590	4.850	119.38	121.92	126.75	134.01	141.99	123.19
100/200	4.950	5.050	5.240	5.526	5.840	5.100	125.73	128.27	133.10	140.36	148.34	129.54
105/210	5.200	5.300	5.490	5.776	6.090	5.350	132.08	134.62	139.45	146.71	154.69	135.89
108/216	5.350	5.450	5.640	5.926	6.240	5.500	135.89	138.43	143.26	150.52	158.50	139.70
110/220	5.450	5.550	5.740	6.026	6.340	5.600	138.43	140.97	145.80	153.06	161.04	142.24
120/240	5.950	6.050	6.240	'N' Mounting Only		6.100	151.13	153.67	158.50	'N' Mounting Only		154.94



.050" [1.27mm] Contact Centers, .915" Insulator Height Right Angle

SPECIFICATIONS

- Accommodates .062" \pm .008" [1.57 \pm .20] PC board
- PPS or PA9T insulator
- Molded-in key available
- High reliability/high cycle hairpin bellows contact
- 1 amp current rating per contact
- 150 grams normal force minimum

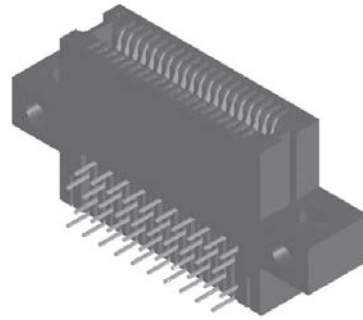

READOUT

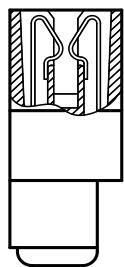

DUAL (D)

TERMINATION TYPE

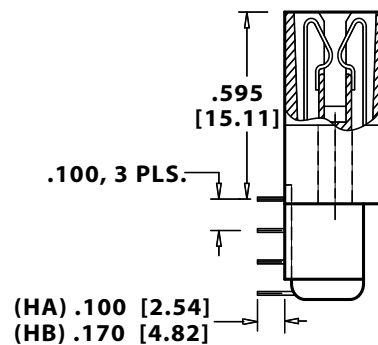

PCB LAYOUT

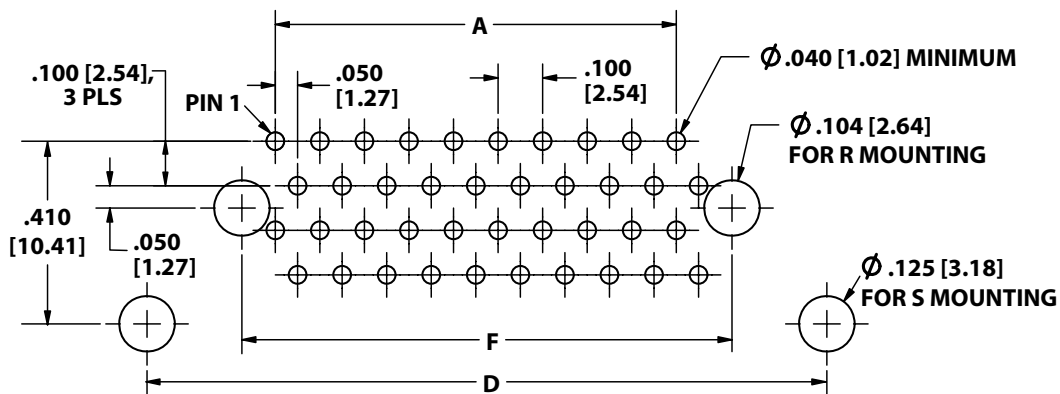

PCB LAYOUT, COMPONENT SIDE

MOUNTING STYLE

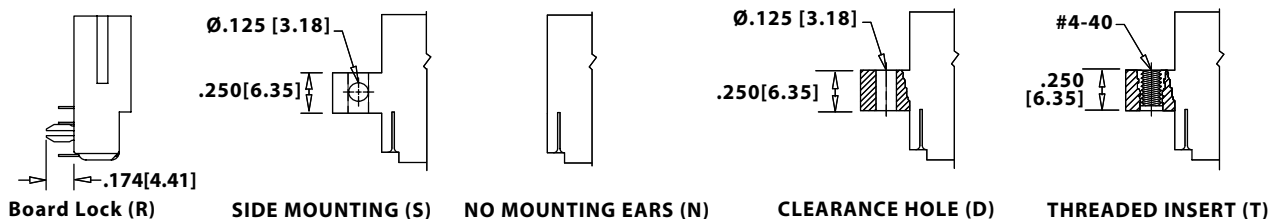



.050" [1.27mm] Contact Centers, .915" Insulator Height Right Angle

PART NUMBER CODING

MATERIALS (INSULATOR/CONTACT)

G = PA9T/Phosphor Bronze
R = PPS/Phosphor Bronze
J = PA9T/Beryllium Copper
A = PPS/Beryllium Copper
(Consult Factory for Other Materials)

CONTACT FINISH - RoHS Compliant

All platings are Lead Free and have .000050" Nickel underplate
Contact Surface **Termination**

B = .000010" Gold .000100" Pure Tin, Matte
C = .000030" Gold .000100" Pure Tin, Matte

CONTACT CENTERS

B = .050" [1.27mm]

G B B 10 D HA S - Sxxx

MODIFICATION CODE (Consult Factory)
OMIT FOR STANDARD

MOUNTING STYLE (Opposite Page)

S = Side Mounting
D = Flush Mounting
N = No Mounting
T = Flush Mounting With Threaded Insert
R = Metal Board Lock

TERMINATION TYPE (Opposite Page)

HA = .100" Staggered Dip Solder, Right Angle
HB = .170" Staggered Dip Solder, Right Angle

READOUT (Opposite Page)

D = Dual

NUMBER OF CONTACT POSITIONS

See Chart Below

DIMENSIONS

Dimensions in [] are in millimeters, all others are in inches.

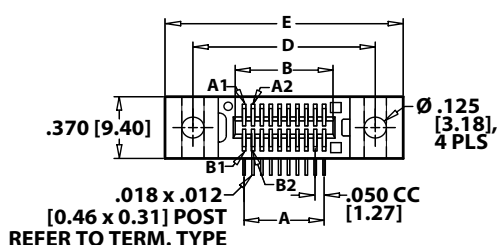

(S) MOUNTING SHOWN

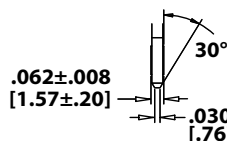
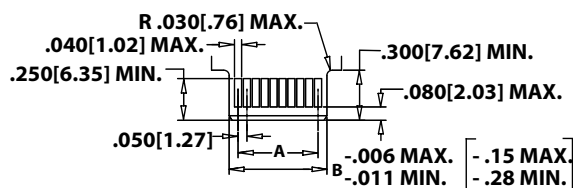
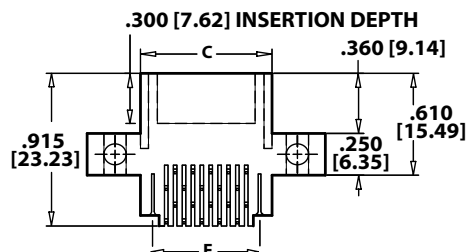

CARD LAYOUT

POSITIONS/ CONTACTS	INCHES						[MILLIMETERS]					
	A ±.005	B ±.005	C ±.015	D ±.010	E ±.020	F ±.010	A ±.13	B ±.13	C ±.38	D ±.25	E ±.51	F ±.25
05/10	0.200	0.300	0.490	0.776	1.090	0.350	5.08	7.62	12.45	19.71	27.69	8.89
06/12	0.250	0.350	0.540	0.826	1.140	0.400	6.35	8.89	13.72	20.98	28.96	10.16
09/18	0.400	0.500	0.690	0.976	1.290	0.550	10.16	12.70	17.53	24.79	32.77	13.97
10/20	0.450	0.550	0.740	1.026	1.340	0.600	11.43	13.97	18.80	26.06	34.04	15.24
13/26	0.600	0.700	0.890	1.176	1.490	0.750	15.24	17.78	22.61	29.87	37.85	19.05
14/28	0.650	0.750	0.940	1.226	1.540	0.800	16.51	19.05	23.88	31.14	39.12	20.32
15/30	0.700	0.800	0.990	1.276	1.590	0.850	17.78	20.32	25.15	32.41	40.39	21.59
20/40	0.950	1.050	1.240	1.526	1.840	1.100	24.13	26.67	31.50	38.76	46.74	27.94
22/44	1.050	1.150	1.340	1.626	1.940	1.200	26.67	29.21	34.04	41.30	49.28	30.48
24/48	1.150	1.250	1.440	1.726	2.040	1.300	29.21	31.75	36.58	43.84	51.82	33.02
25/50	1.200	1.300	1.490	1.776	2.090	1.350	30.48	33.02	37.85	45.11	53.09	34.29
30/60	1.450	1.550	1.740	2.026	2.340	1.600	36.83	39.37	44.20	51.46	59.44	40.64
34/68	1.650	1.750	1.940	2.226	2.540	1.800	41.91	44.45	49.28	56.54	64.52	45.72
35/70	1.700	1.800	1.990	2.276	2.590	1.850	43.18	45.72	50.55	57.81	65.79	46.99
40/80	1.950	2.050	2.240	2.526	2.840	2.100	49.53	52.07	56.90	64.16	72.14	53.34
45/90	2.200	2.300	2.490	2.776	3.090	2.350	55.88	58.42	63.25	70.51	78.49	59.69
50/100	2.450	2.550	2.740	3.026	3.340	2.600	62.23	64.77	69.60	76.86	84.84	66.04
55/110	2.700	2.800	2.990	3.276	3.590	2.850	68.58	71.12	75.95	83.21	91.19	72.39
60/120	2.950	3.050	3.240	3.526	3.840	3.100	74.93	77.47	82.30	89.56	97.54	78.74
64/128	3.150	3.250	3.440	3.726	4.040	3.300	80.01	82.55	87.38	94.64	102.62	83.82
65/130	3.200	3.300	3.490	3.776	4.090	3.350	81.28	83.82	88.65	95.91	103.89	85.09
66/132	3.250	3.350	3.540	3.826	4.140	3.400	82.55	85.09	89.92	97.18	105.16	86.36
70/140	3.450	3.550	3.740	4.026	4.340	3.600	87.63	90.17	95.00	102.26	110.24	91.44
75/150	3.700	3.800	3.990	4.276	4.590	3.850	93.98	96.52	101.35	108.61	116.59	97.79
80/160	3.950	4.050	4.240	4.526	4.840	4.100	100.33	102.87	107.70	114.96	122.94	104.14
85/170	4.200	4.300	4.490	4.776	5.090	4.350	106.68	109.22	114.05	121.31	129.29	110.49
90/180	4.450	4.550	4.740	5.026	5.340	4.600	113.03	115.57	120.40	127.66	135.64	116.84
95/190	4.700	4.800	4.990	5.276	5.590	4.850	119.38	121.92	126.75	134.01	141.99	123.19
100/200	4.950	5.050	5.240	5.526	5.840	5.100	125.73	128.27	133.10	140.36	148.34	129.54
105/210	5.200	5.300	5.490	5.776	6.090	5.350	132.08	134.62	139.45	146.71	154.69	135.89
108/216	5.350	5.450	5.640	5.926	6.240	5.500	135.89	138.43	143.26	150.52	158.50	139.70
110/220	5.450	5.550	5.740	6.026	6.340	5.600	138.43	140.97	145.80	153.06	161.04	142.24
120/240	5.950	6.050	6.240	'N' Mounting Only	6.100		151.13	153.67	158.50	'N' Mounting Only		154.94



Sullins Edgecards

.050" [1.27mm] Contact Centers, .610" Insulator Height
[MCA] Dip Solder/Card Extender/SMT

Industry Standard Part

SPECIFICATIONS

- Accommodates $.062" \pm .008"$ [1.57 \pm .20] PC board (Consult factory for other board thicknesses)
- PPS or PA9T insulator
- Molded-in key available
- High reliability/high cycle hairpin bellows contact
- 1 amp current rating per contact
- 150 grams normal force minimum

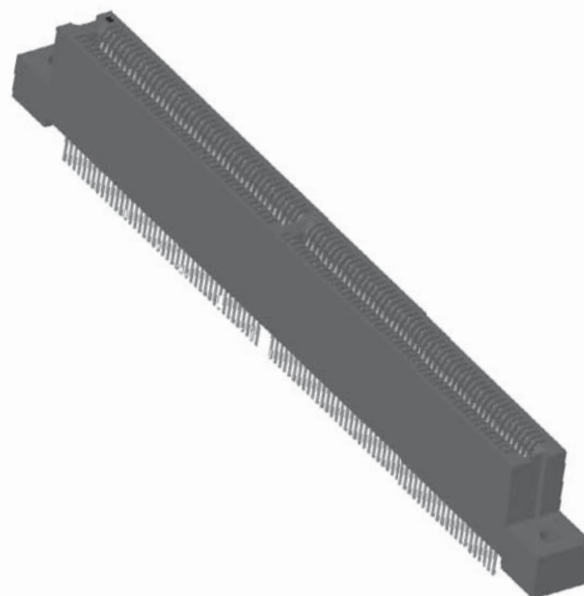

READOUT

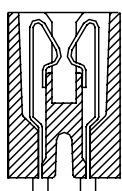

DUAL (D)

TERMINATION TYPE

Consult Factory for PC Board Layouts

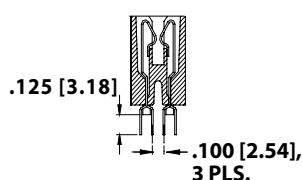

STAGGERED DIP SOLDER (HH)

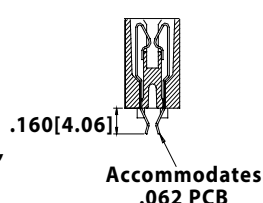

CARD EXTENDER (HR)

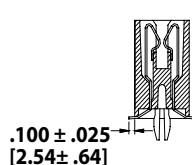

SURFACE MOUNT (HF)

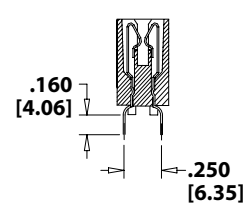

DIP SOLDER (HL)

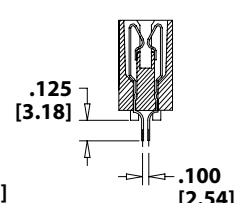

DIP SOLDER (HN)

MOUNTING STYLE

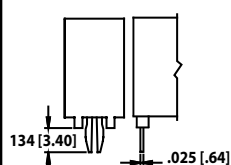

BOARD LOCK (R)

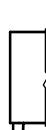

NO MOUNTING EARS (N)

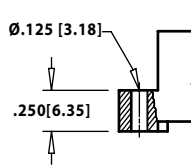

FLUSH MOUNTING (D)

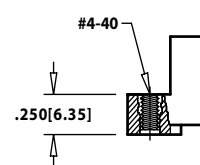

FLUSH MOUNTING WITH THREADED INSERT (T)

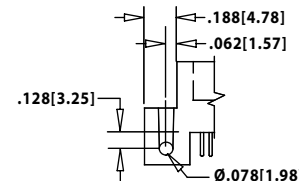

STRADDLE MOUNT (Q)



.050" [1.27mm] Contact Centers, .610" Insulator Height [MCA] Dip Solder/Card Extender/SMT

Industry Standard Part

PART NUMBER CODING

MATERIALS (Insulator/Contact)

G = PA9T/Phosphor Bronze
R = PPS/Phosphor Bronze
J = PA9T/Beryllium Copper
A = PPS/Beryllium Copper
(Consult Factory for Other Materials)

CONTACT FINISH - RoHS Compliant

All platings are Lead Free and have .000050" Nickel underplate

Contact Surface

B = .000010" Gold .000100" Pure Tin, Matte
C = .000030" Gold .000100" Pure Tin, Matte

Termination

CONTACT CENTERS

B = .050" [1.27mm]

NUMBER OF CONTACT POSITIONS

56, 66, 91, 106

G B B 56 D HH D - S578

MODIFICATION (Consult Factory)

-S578 = Card Slot Barriers With Guide Posts
-S621 = Card Slot Barriers Without Guide Posts

MOUNTING STYLE

N = No Mounting
D = Flush Mounting
T = Flush Mounting With Threaded Insert
Q = Straddle Mount (Card Extender Only)
R = Metal Board Lock

TERMINATION TYPE

HH = Staggered Dip Solder
HR = Card Extender
HF = Surface Mount
HL = .250" [6.35mm] x .160" [4.06mm] Dip Solder
HN = .100" [2.54mm] x .125" [3.18mm] Dip Solder
(REPLACES TERMINATIONS: CH, CR, CF, CL, CN)

READOUT

D = Dual

DIMENSIONS

Dimensions in [] are in millimeters, all others are in inches.

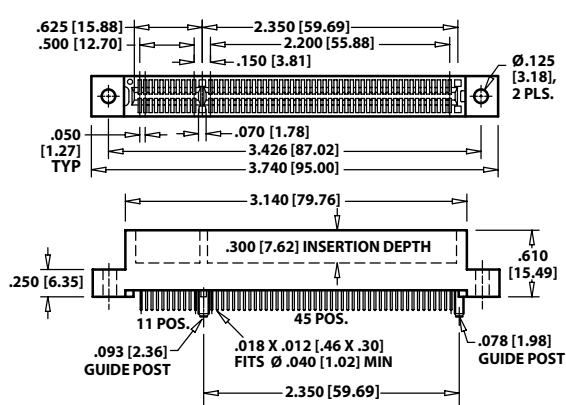

GBB56DHHD-S578, 56 (11/45) POSITIONS

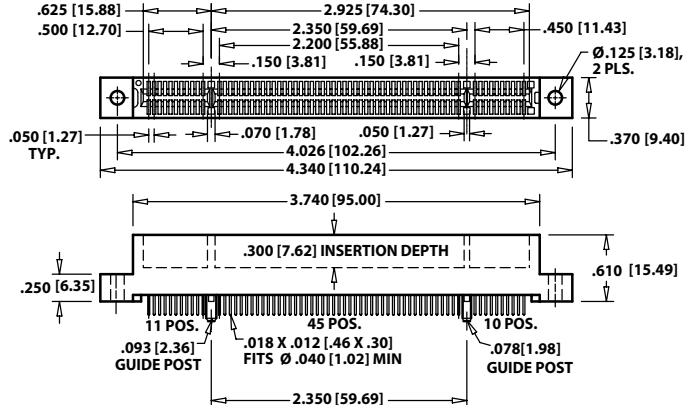

GBB66DHHD-S578, 66 (11/45/10) POSITIONS

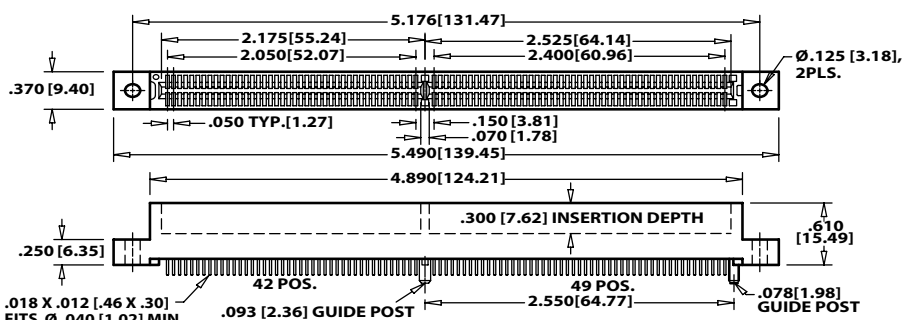

GBB91DHHD-S578, 91 (42/49) POSITIONS

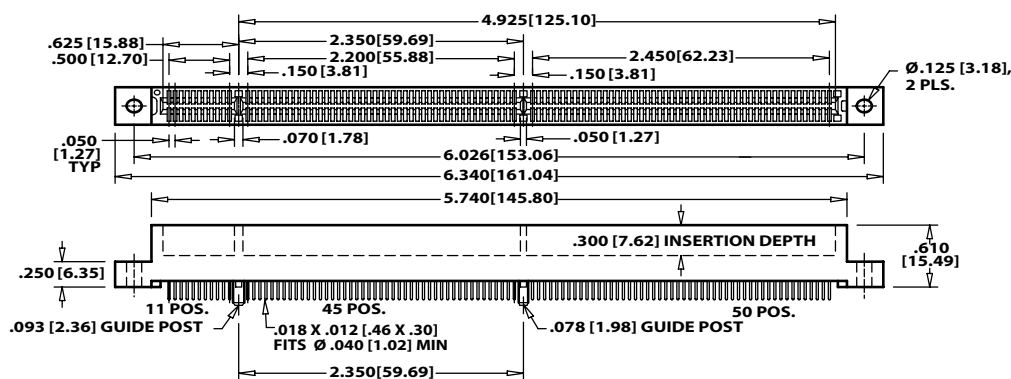

GBB106DHHD-S578, 106 (11/45/50) POSITIONS

DIMENSIONS

Dimensions in [] are in millimeters, all others are in inches.

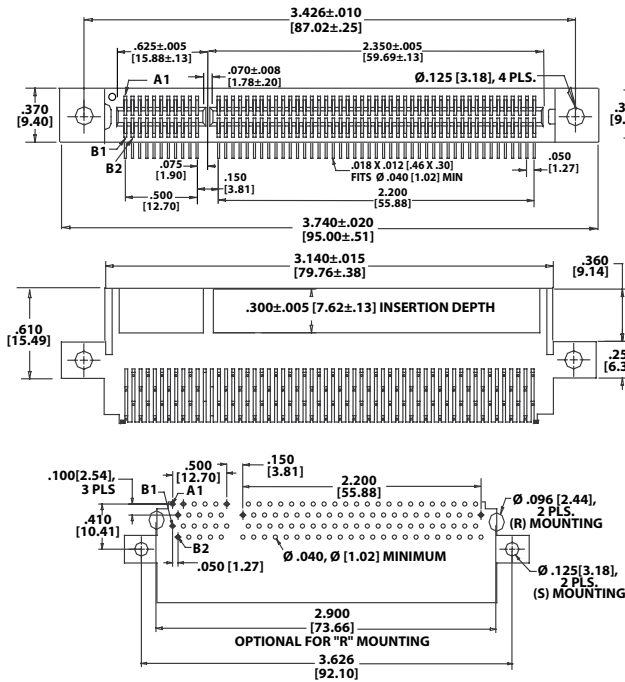

GBB56DHAS-S621, 56(11/45) POSITIONS

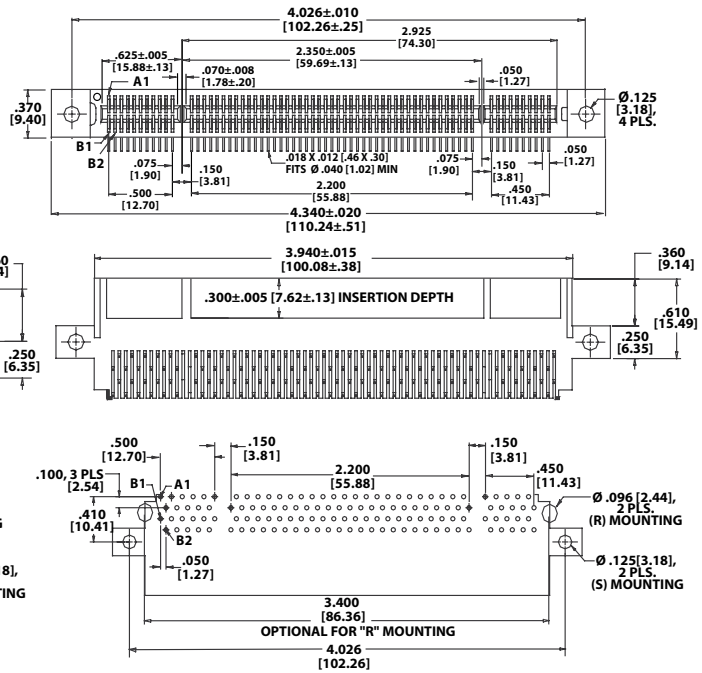

GBB66DHAS-S621, 66(11/45/10) POSITIONS

MOUNTING STYLE

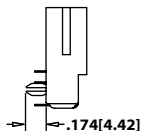

BOARD LOCK (R)
(Consult Factory)

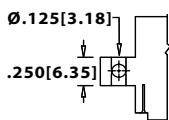

SIDE MOUNTING (S)



NO MOUNTING EARS (N)

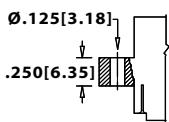

FLUSH MOUNTING (D)

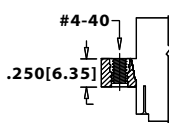

THREADED INSERT (T)

DIMENSIONS

Dimensions in [] are in millimeters, all others are in inches.

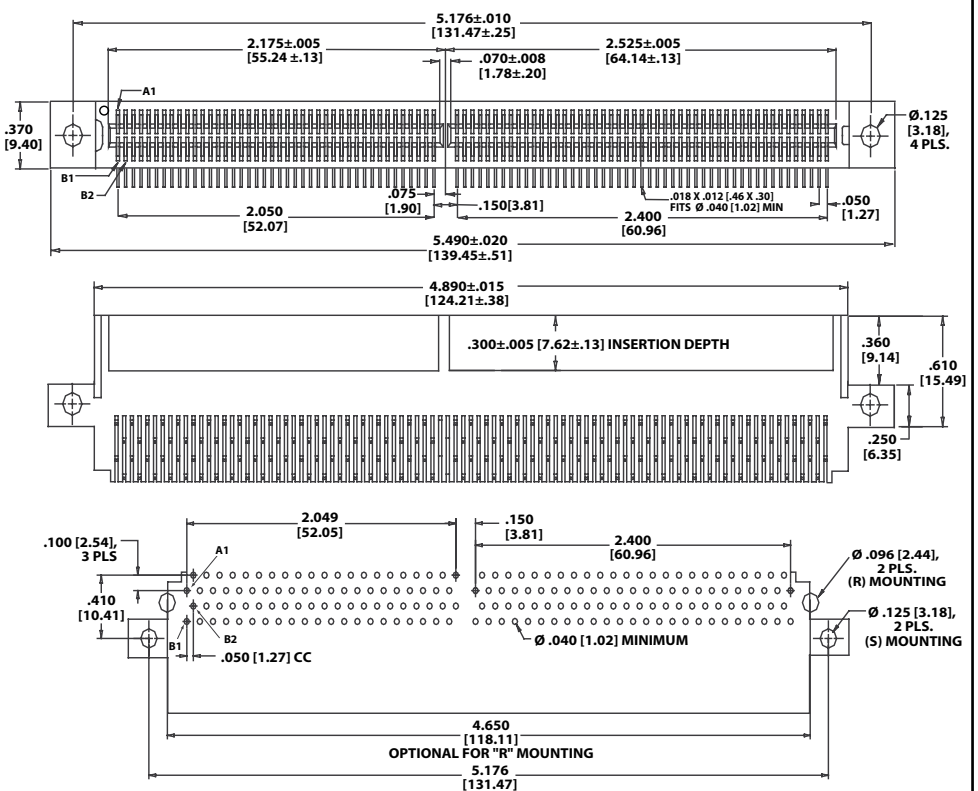

GBB91DHAS-S621, 91 (42/49) POSITIONS

**.050" [1.27mm] Contact Centers, .915" Insulator Height
[MCA] Right Angle**

Industry Standard Part

PART NUMBER CODING

MATERIALS (Insulator/Contact)

G = PA9T/Phosphor Bronze
R = PPS/Phosphor Bronze
J = PA9T/Beryllium Copper
A = PPS/Beryllium Copper
(Consult Factory for Other Materials)

CONTACT FINISH - RoHS Compliant

All platings are Lead Free and have .000050" Nickel underplate

Contact Surface

B = .000010" Gold
C = .000030" Gold

Termination

.000100" Pure Tin, Matte
.000100" Pure Tin, Matte

CONTACT CENTERS

B = .050" [1.27mm]

G B B 56 D HA D - S621

MODIFICATION (CONSULT FACTORY)

-S621 = Card Slot Barriers Without Guide Posts

MOUNTING STYLE (Opposite Page)

S = Side Mounting
D = Flush Mounting
N = No Mounting
T = Flush Mounting With Threaded Insert
R = Metal Board Lock

TERMINATION TYPE

HA = .100" [2.54] Staggered Dip Solder, Right Angle
HB = .170" [4.32] Staggered Dip Solder, Right Angle

READOUT

D = Dual

NUMBER OF CONTACT POSITIONS

56 = 11/45
66 = 11/45/10
91 = 42/49
106 = 11/45/50

TERMINATION TYPE

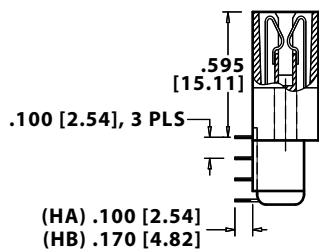

SPECIFICATIONS

- Accommodates .062" ± .008" [1.57 ± .20] PC board
- PPS or PA9T insulator
- Molded-in key available
- High reliability/high cycle hairpin bellows contact
- 1 amp current rating per contact
- 150 grams normal force minimum

DIMENSIONS

Dimensions in [] are in millimeters, all others are in inches.

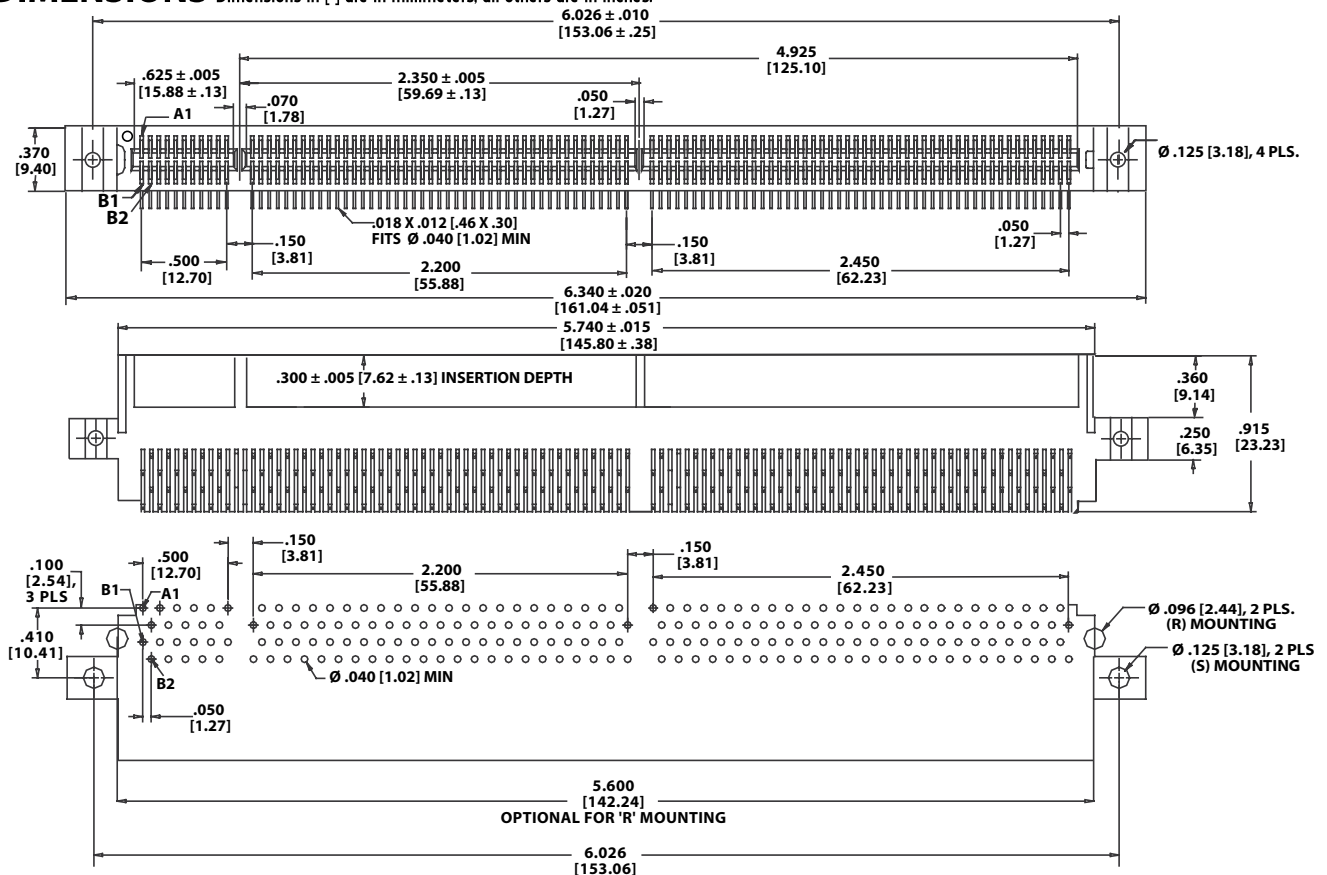

**BOARD LAYOUT, CONNECTOR SIDE
GBB106DHAS-S621, 64 BIT, 5 VOLT**



SPECIFICATIONS

- Accommodates .062" \pm .008" [1.57 \pm .20] PC board
- PPS or PA9T insulator
- Molded-in key available
- High reliability/high cycle hairpin bellows contact
- 1 amp current rating per contact
- 150 grams normal force minimum

READOUT

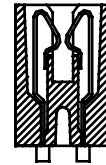

DUAL (D)

DIMENSIONS

Dimensions in [] are in millimeters, all others are in inches.

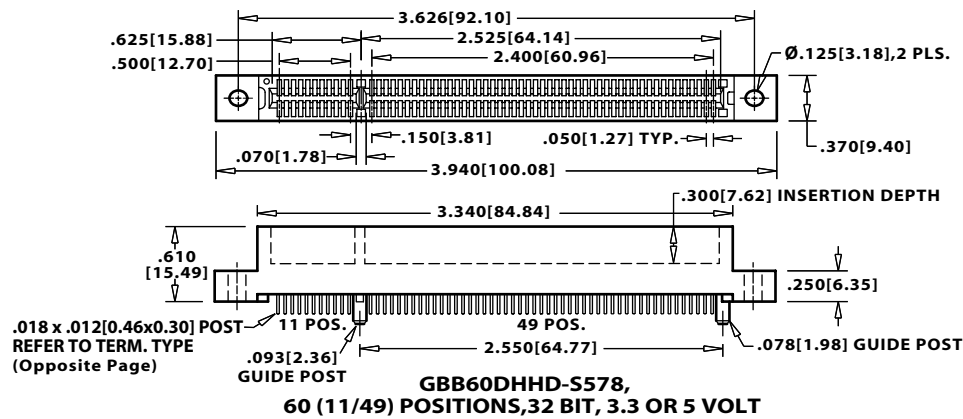

**GBB60DHHD-S578,
60 (11/49) POSITIONS, 32 BIT, 3.3 OR 5 VOLT**

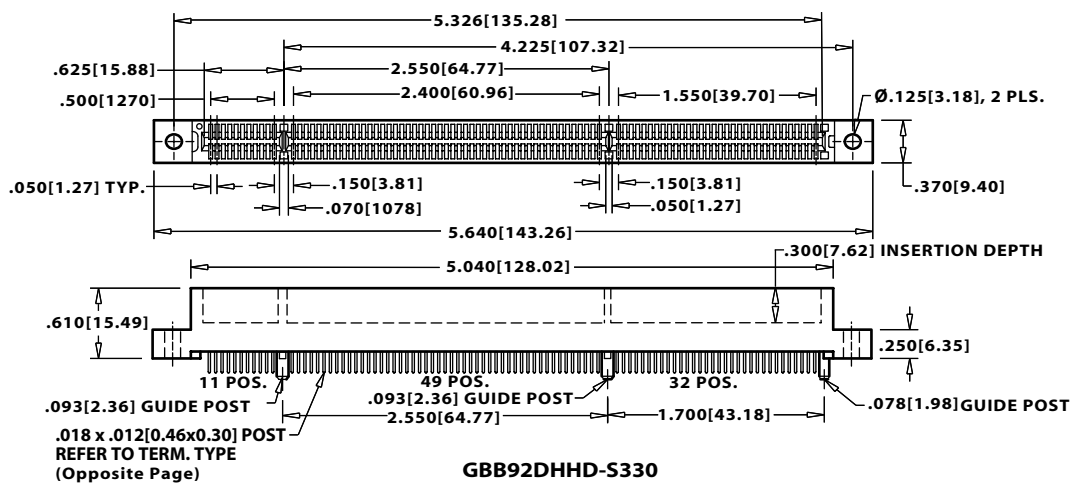

**GBB92DHHD-S330
92 (11/49/32) POSITIONS, 64 BIT, 3.3 VOLT**

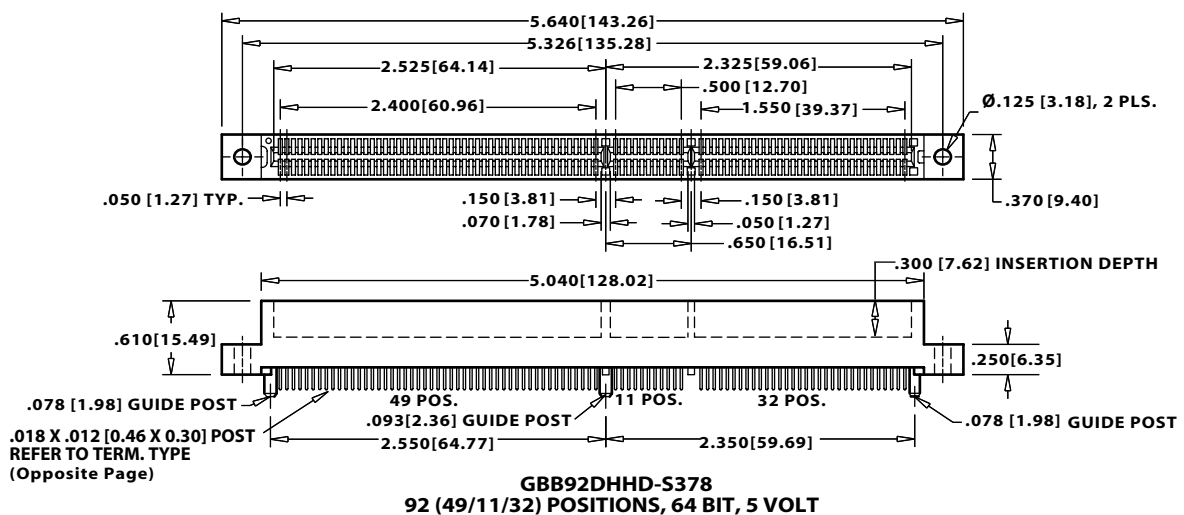

**GBB92DHHD-S378
92 (49/11/32) POSITIONS, 64 BIT, 5 VOLT**

.050" [1.27mm] Contact Centers, .610" Insulator Height [PCI] Dip Solder/Card Extender/SMT

Industry Standard Part

PART NUMBER CODING

MATERIALS (Insulator/Contact)

G = PA9T/Phosphor Bronze
R = PPS/Phosphor Bronze
J = PA9T/Beryllium Copper
A = PPS/Beryllium Copper
(Consult Factory for Other Materials)

CONTACT FINISH - RoHS Compliant

All platings are Lead Free and have .000050" Nickel underplate

Contact Surface

B = .000010" Gold
C = .000030" Gold

Termination

.000100" Pure Tin, Matte
.000100" Pure Tin, Matte

CONTACT CENTERS

B = .050" [1.27mm]

NUMBER OF CONTACT POSITIONS

60 = 11/49 (32 Bit, 3.3 or 5 Volt)
92 = 11/49/32 (64 Bit, 3.3 Volt)
or 92 = 49/11/32 (64 Bit, 5 Volt)

READOUT

D = Dual

G B B 60 D HH D - S578

MODIFICATION (CONSULT FACTORY)

PCI WITH GUIDE POSTS

*-S578 = 60 (11/49) Positions(32 Bit, 3.3 or 5 Volt)
-S330 = 92 (11/49/32) Positions(64 Bit, 3.3 Volt)
-S378 = 92 (49/11/32) Positions(64 Bit, 5 Volt)

PCI WITHOUT GUIDE POSTS

*-S621 = 60 (11/49) Positions(32 Bit, 3.3 or 5 Volt)
-S329 = 92 (11/49/32) Positions(64 Bit, 3.3 Volt)
-S250 = 92 (49/11/32) Positions(64 Bit, 5 Volt)

* Turn connector or board 180° to switch from 3.3 to 5 volt

MOUNTING STYLE

D = Flush Mounting
N = No Mounting
T = Flush Mounting With Threaded Insert
Q = Straddle Mount (Card Extender Only)
R = Metal Boardlocks

TERMINATION TYPE

HH = Staggered Dip Solder
HR = Card Extender
HF = Surface Mount
HL = .250" [6.35mm] x .160" [4.06mm] Dip Solder
HN = .100" [2.54mm] x .125" [3.18mm] Dip Solder
(REPLACES TERMINATIONS: CH, CR, CF, CL, CN)

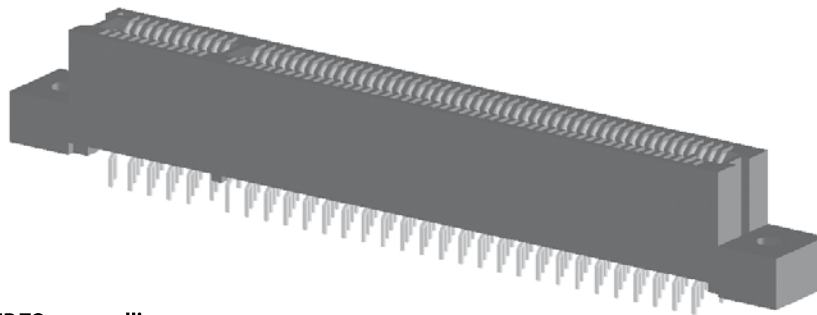

FOR PC BOARD LAYOUTS REFER TO www.sullinscorp.com

TERMINATION TYPE

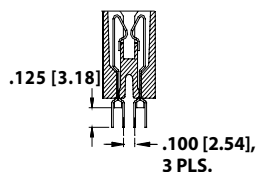

STAGGERED DIP SOLDER
(HH)

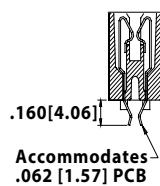

CARD EXTENDER
(HR)

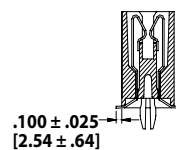

SURFACE MOUNT
(HF)

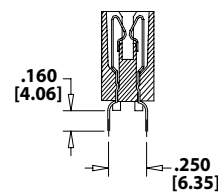

DIP SOLDER
(HL)

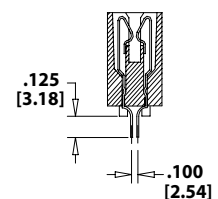

DIP SOLDER
(HN)

MOUNTING STYLE



NO MOUNTING EARS
(N)

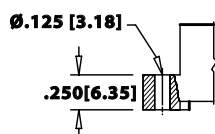

FLUSH MOUNTING
(D)

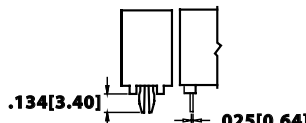

METAL BOARD LOCK (R)

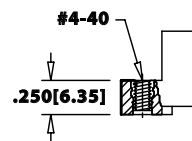

FLUSH MOUNTING
WITH THREADED INSERT
(T)

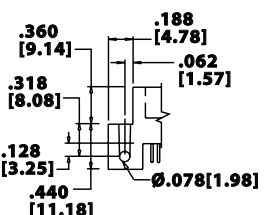

STRADDLE MOUNT (Q)
Formerly (Z)



• Dimensions in [] are in millimeters, all others are in inches.

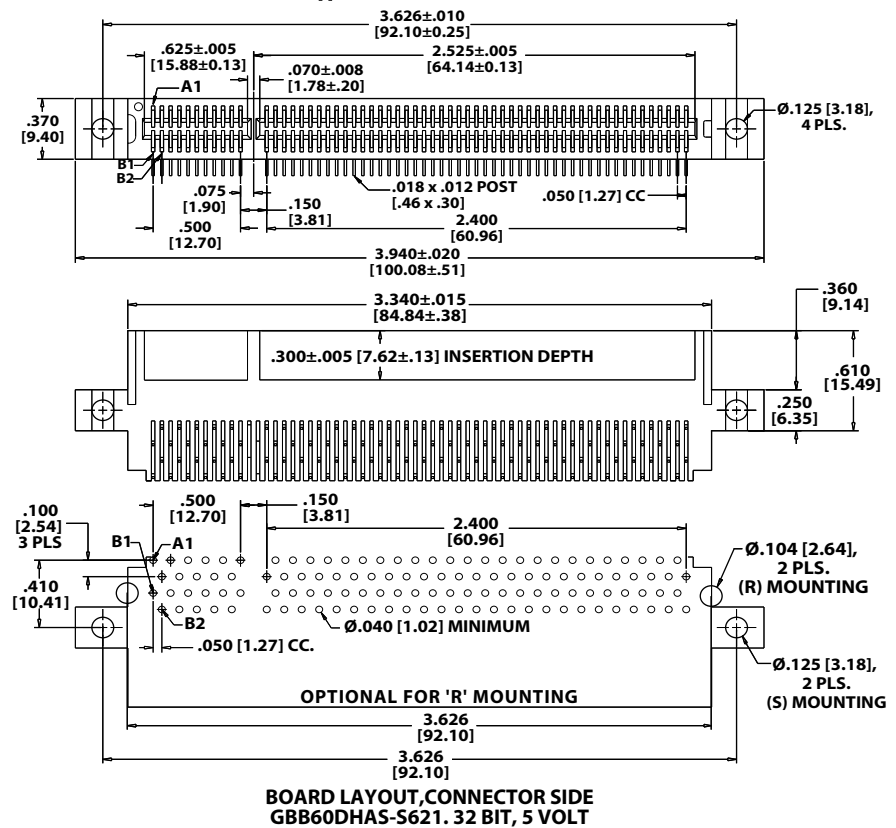

Dimensions in [] are in millimeters, all others are in inches.

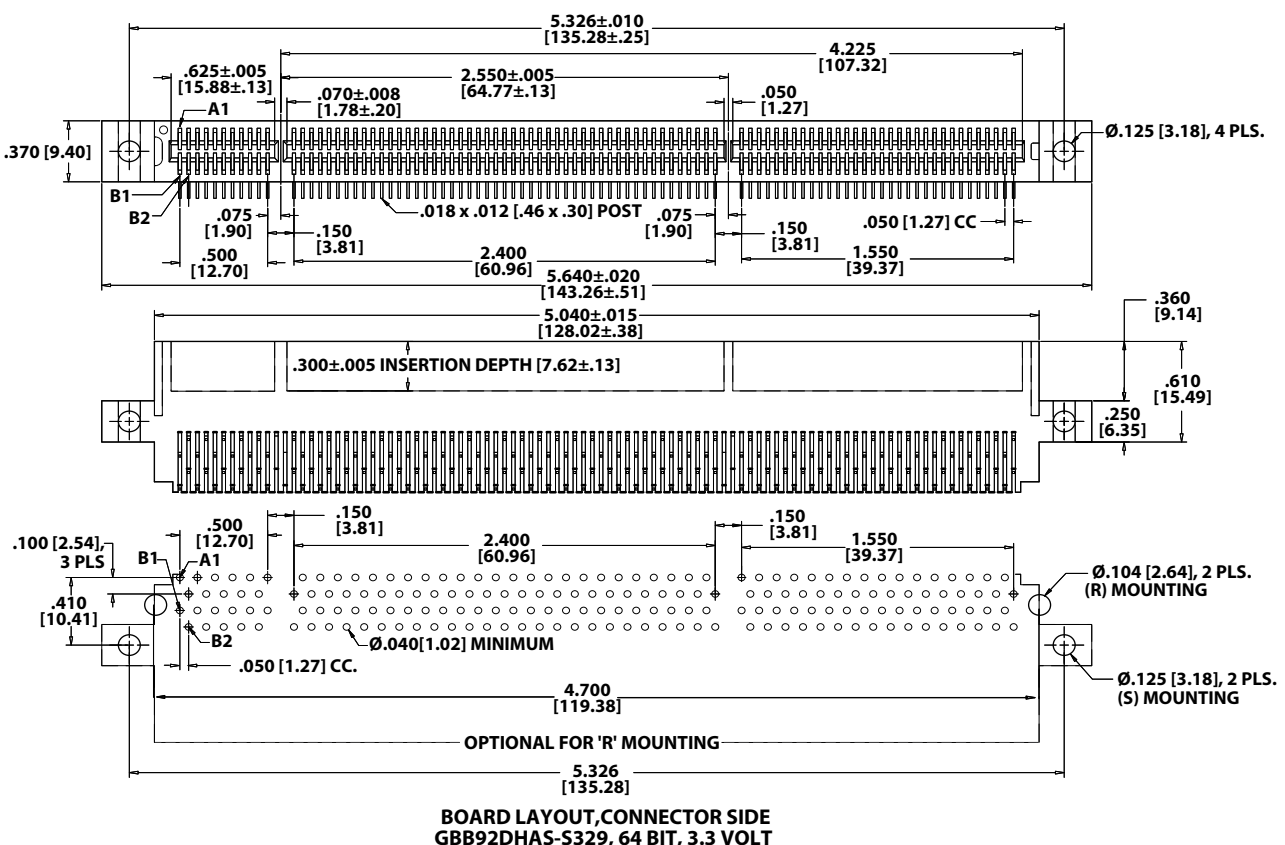

**.050" [1.27mm] Contact Centers, .915" Insulator Height
[PCI] Right Angle**

Industry Standard Part

PART NUMBER CODING

G B B 60 D HA D-S793

MATERIALS (Insulator/Contact)

G = PA9T/Phosphor Bronze
R = PPS/Phosphor Bronze
J = PA9T/Beryllium Copper
A = PPS/Beryllium Copper
(Consult Factory for Other Materials)

CONTACT FINISH - RoHS Compliant

All platings are Lead Free and have .000050" Nickel underplate

	Contact Surface	Termination
B =	.000010" Gold	.000100" Pure Tin, Matte
C =	.000030" Gold	.000100" Pure Tin, Matte

CONTACT CENTERS

$$B = .050'' [1.27\text{mm}]$$

NUMBER OF CONTACT POSITIONS

60 = 11/49 (32 Bit, 3.3 or 5 Volt)
92 = 11/49/32 (64 Bit, 3.3 Volt)
or 92 = 49/11/32 (64 Bit, 5 Volt)

— **MODIFICATION** (CONSULT FACTORY)

-S793 = 60(49/11) Reverse Bend (32 Bit, 3.3 Volt)
 -S621 = 60(11/49) Positions (32 Bit, 5 Volt)
 -S329 = 92(11/49/32) Positions (64 Bit, 3.3 Volt)
 -S250 = 92(49/11/32) Positions (64 Bit, 5 Volt)

— MOUNTING STYLE

S = Side Mounting
D = Flush Mounting
N = No Mounting
T = Flush Mounting With Threaded Insert
R = Metal Board Lock

—TERMINATION TYPE (Opposite Page)

HA = .100" [2.54mm] Staggered Dip Solder
HB = .170" [4.32mm] Staggered Dip Solder

—**READOUT**

D = Dual

DIMENSIONS Dimensions in [] are in millimeters, all others are in inches.

Dimensions in [] are in millimeters, all others are in inches.

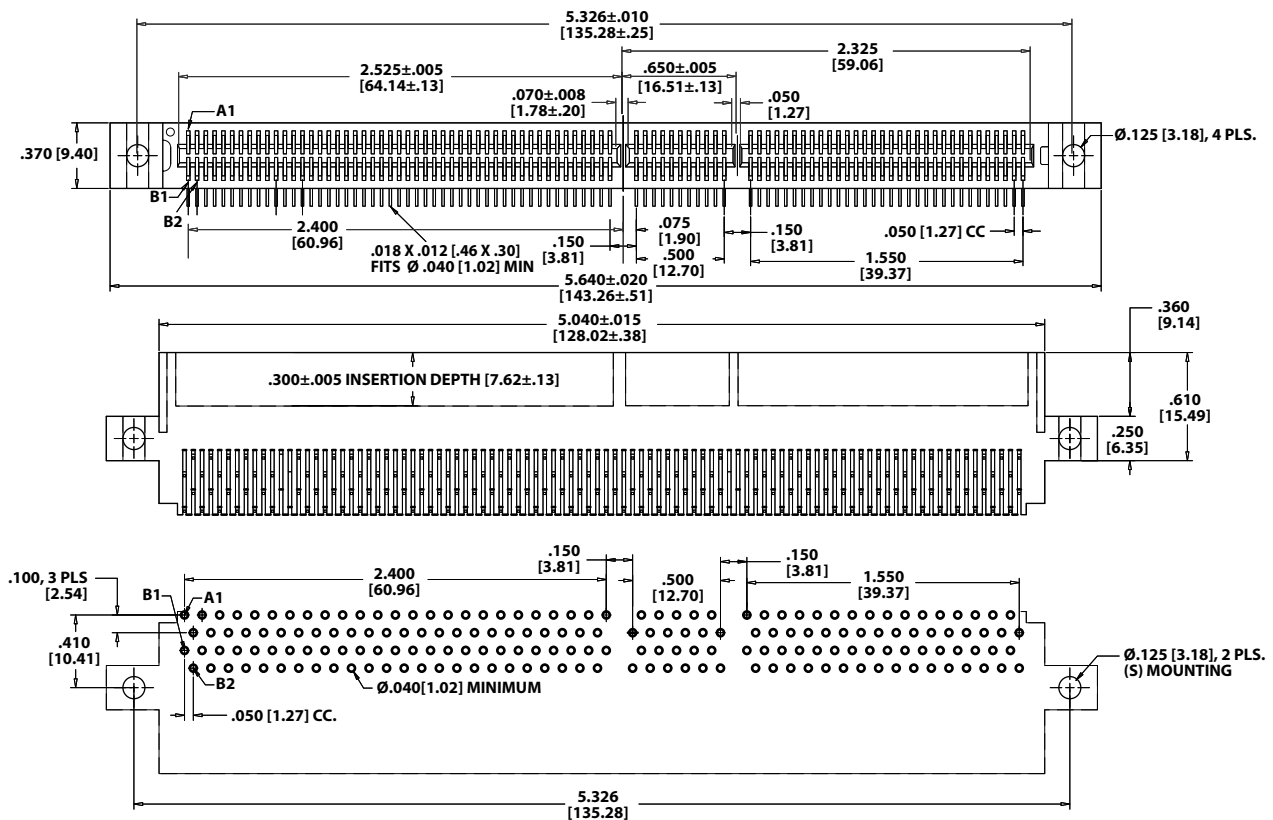

BOARD LAYOUT,CONNECTOR SIDE
GBB92DHAS-S250, 64 BIT, 5 VOLT

MOUNTING STYLE

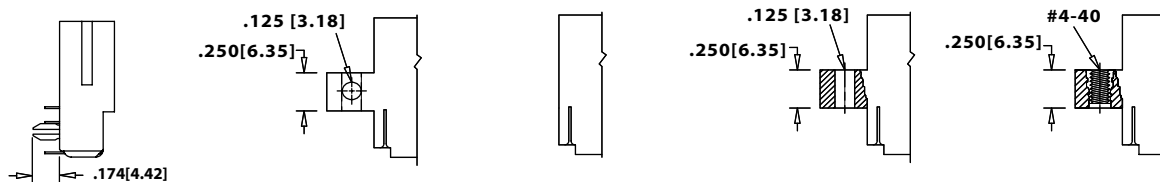

BOARD LOCK (R)

SIDE MOUNTING (S)

NO MOUNTING EARS (N)

FLUSH MOUNTING (D)

THREADED INSERT (T)



GENERAL SPECIFICATIONS

RoHS COMPLIANT

RoHS
COMPLIANT

All parts are currently manufactured with recommended materials to meet RoHS standards. All contacts have 50u" of nickel underplating, and a large selection of plating options: Pure tin matte, overall gold, or selective gold plating. For complete part number information or operating/processing temperature parameters, visit the RoHS section of our website, or refer to page 5 of this catalog.

MATERIALS

Insulator

- PBT, Valox*, Thermoplastic Polyester
- PPS, Ryton*, Polyphenylene Sulfide
- PEEK, Polyetheretherketone
- PA9T, High Temperature Polyamide
- Other materials available. Consult Factory

Contacts

Phosphor Bronze (Standard), Beryllium Copper, Beryllium Nickel, Spinodal**, Brass

Plating

Gold and/or Tin over .000050" Nickel Underplate, Lead Free

UL/CUL File Number: E64287

Cage Code: 54453

MECHANICAL

Board Insertion Force 16 oz Maximum per contact pair using .062"[1.58mm] thick steel test blade

Board Withdrawal Force 1 oz Minimum per contact pair using .062"[1.58mm] thick steel test blade

Special Insertion/Withdrawal forces available upon request

ELECTRICAL

Insulation Resistance: 5,000 Mega Ohm

Dielectric Withstanding Voltage

Contact Centers:	.039"[1mm]	.050"[1.27mm]	.100"[2.54mm]	.125"[3.18mm]	.150"[3.81mm]	.156"[3.96mm]
Voltage:	125 VDC	250 VDC	600 VDC	800 VDC	1500 VDC	1800 VDC
	225 VAC	300 VAC	750 VAC	750 VAC	900 VAC	950 VAC

Current Rating: 1 to 5 amp per contact

Voltage Drop: 30 milli volt at rated current

Contact Resistance: 30 milli ohm maximum at rated current

ENVIRONMENTAL

Solvent resistance: Perchloroethylene, Freon 113, Freon 11, Trichloroethylene

Operating Temperature:	PBT	-65° to +130°C	Phosphor Bronze	-65° to +125°C
	PPS	-65° to +200/220°C***	Beryllium Copper	-65° to +150°C
	PEEK	-65° to +250°C***	Spinodal**	-65° to +200°C
	PA9T	-65° to +150°C	Beryllium Nickel***	-65° to +300°C
(Continuous temperatures, higher for short duration. Contact Factory for details.)				

* Or equivalent.

** Consult factory for special soldering guidelines.

*** Consult factory.



PART NUMBER OPTIONS

MATERIALS (Insulator/Contact)		MODIFICATION CODE (Consult Factory) OMIT FOR STANDARD	
E = PBT & Phosphor Bronze OPERATING TEMPERATURE: -65°C to +125°C PROCESSING TEMP: 260°C FOR 10 sec. MAX. (230°C, 30 sec.)		MOUNTING STYLE	
R = PPS & Phosphor Bronze OPERATING TEMPERATURE: -65°C to +125°C PROCESSING TEMPERATURE: 260°C FOR 120 sec. MAX.		H = Clearance Holes, .125" [3.18mm] Dia	
G = PA9T & PHOSPHOR BRONZE OPERATING TEMPERATURE: -65°C to +125°C PROCESSING TEMPERATURE: 260° FOR 120 sec. MAX.		N = No Mounting	
H = PBT & Beryllium Copper OPERATING TEMPERATURE: -65°C to +125°C PROCESSING TEMP: 260°C FOR 10 sec. MAX. (230°C, 30 sec.)		S = Side Mounting, .125" [3.18mm] Dia	
A = PPS & Beryllium Copper OPERATING TEMPERATURE: -65°C to +150°C PROCESSING TEMPERATURE: 260°C FOR 120 sec. MAX.		I = #4-40 Threaded Insert	
J = PA9T & Beryllium Copper OPERATING TEMPERATURE: -65°C to +150°C PROCESSING TEMPERATURE: 260°C FOR 120 sec. MAX.		F = Floating Bobbin	
M = White PA9T/Beryllium Copper OPERATING TEMPERATURE: -65°C to +150°C		W = .430" Ears, Flush Mounting, .125" [3.18mm] Dia	
F = PPS & Spinodal (Consult Factory) OPERATING TEMPERATURE: -65°C to +200°C		D = .250" Ears, Flush Mounting, .125" [3.18mm] Dia	
C = PPS & Beryllium Nickel (Consult Factory) OPERATING TEMPERATURE: -65°C to +200°C PROCESSING TEMPERATURE: 260°C FOR 120 sec. MAX.		P = Clearance Holes, .142" [3.61mm] Dia.	
W = PEEK & Beryllium Nickel (Consult Factory) OPERATING TEMPERATURE: -65°C to +250°C		B = Open Card Slot	
N = Nylon 6T & Phosphor Bronze OPERATING TEMPERATURE: -10°C to +85°C PROCESSING TEMPERATURE: 260°C for 10 sec. MAX.		X = .430" Ears, Flush Mounting, #4-40 Threaded Insert	
		T = .250" Ears, Flush Mounting, #4-40 Threaded Insert	
		Q = Straddle Mount	
		Z = .250" Ears, Flush, Side Mounting	
		TERMINATION TYPE	
		Card Extender	
		HR = .050" & 1mm Contact Centers	
		KR,KN = .025"[.64mm] Square Post, Cantilever	
		Dip Solder - High Profile	
		RS = .025 [.64mm] Square Tail, Loop Bellows	
		CS,SC = .025" [.64mm] Square Tail, Hairpin Bellows	
		TK = .026" [.66mm] Round Tail, Loop Bellows	
		CT,CW = .015" x .025" Tail, Hairpin Bellows	
		CK = .026" [.66mm] Round Tail, Loop Bellows	
		HH = 1mm [.039"] Contact Centers	
		HH,HL,HN = .050" Contact Centers	
		KS,KD = .025"[.64mm] Square Post, Cantilever	
		Dip Solder - Low Profile	
		SX,SU = Crimp to Center for Single Readout	
		RT,RK,RY = .140" [3.56mm] Row Spacing	
		RX,RF,RU,RP = .200" [5.08mm] Row Spacing	
		RJ = .250"[6.35mm] Row Spacing	
		Eyelet	
		RE,TE,SE = Eyelet Tail	
		Press Fit	
		.200"[5.08mm] Row Spacing .100"[2.54mm] Row Spacing	
		JB = .025"[.64mm] Sq. Post JF = .025"[.64mm] Sq. Po	
		JC = .025"[.64mm] Sq. Post JG = .025"[.64mm] Sq. Po	
		JW = .025"[.64mm] Sq. Post JY = .025"[.64mm] Sq. Po	
		JX = .025"[.64mm] Sq. Post JZ = .025"[.64mm] Sq. Po	
		Right Angle	
		RA,SA = Right Angle, Full Bellows	
		TA,TB,TM = Right Angle, Loop Bellows	
		CA,CB,CC = Right Angle, Hairpin Bellows	
		HA = Right Angle, .050" & 1mm Contact Centers	
		HB = Right Angle, .050" Contact Centers	
		KA,KE,KU,KJ = .025"[.64mm] Square Post, Cantilever	
		Surface Mount	
		HF = Surface Mount, .050" & 1mm Contact Centers	
		Wire Wrap	
		RM = .025"[.64mm] Square Post, Loop Bellows	
		CM,MC = .025"[.64mm] Square Post, Hairpin Bellows	
		KK = .031" [.79mm] x .062" [1.58mm] Post	
		KL = .031" [.79mm] x .062" [1.58mm] Post Twisted 90°	
		KM = .025"[.64mm] Square Post, Cantilever	
		WW = .045" [1.14mm] Square Post	
		Bi-Level Terminations	
		LR = Card Extender	
		LT = Dip Solder	
		KB = Right Angle	
		Male Edgcards	
		MW,MS = Dip Solder	
		MA,MV,MB = Right Angle	
		MD,MJ,MK = Right Angle	
		MR,MN = Card Extender	
		MM = Wire Wrap	

E	B	M	43	D	RT	H	- Sxxx
CONTACT FINISH - RoHS Compliant							
All platings are Lead Free and have .000050" Nickel underplate							
Contact Surface				Termination			
B = .000010" Gold				.000100" Pure Tin, Matte			
C = .000030" Gold				.000100" Pure Tin, Matte			
G = .000010" Gold				.000005" Gold			
Y = .000030" Gold				.000005" Gold			
Contact Surface				Overall Plating			
S = .000010" Gold				.000010" Gold			
M = .000030" Gold				.000010" Gold			
E = .000100" Pure Tin, Matte				.000100" Pure Tin, Matte			
CONTACT CENTERS							
E = 1.00mm [.039"]							
B = .050" [1.27 mm]							
K = .078" [1.98 mm]							
C = .100" [2.54 mm]							
A = .125" [3.18 mm]							
J = .150" [3.84 mm]							
M = .156" [3.96 mm]							
NUMBER OF CONTACT POSITIONS							
See applicable specification page							
READOUT							
D = Dual							
D = Dual Row/ Crimp to Center for Single Readout							
H = Half Loaded							
M = Male Edgcard							
Registered Trademarks							
Sabic Innovative Plastics: Valox				Sullins Electronics: Zero Lead Time			
Phillips 66: Ryton				Sullins Electronics: Sullins			
Gardner-Denver Co.: Wire Wrap				Underwriters Labs: UL			
RTP Compounder: PEEK				Ametek: Spinodal			
Specifications are subject to change without notice.							