

WB06-DB

CUSTOMER PRODUCT SPECIFICATION SHEET

RoHS
Compliant

WB06-DB :-1.20mm WTB FEMALE HOUSING, WIRE TYPE, SINGLE ROW - 02 to 06 CONTACTS

SPECIFICATIONS:

OPERATING TEMPERATURE RANGE: -25°C TO + 85°C

APPLICATION WIRES: AWG#28 TO #30

MATERIAL: PA66, UL 94V-0

COLOR: BLACK.

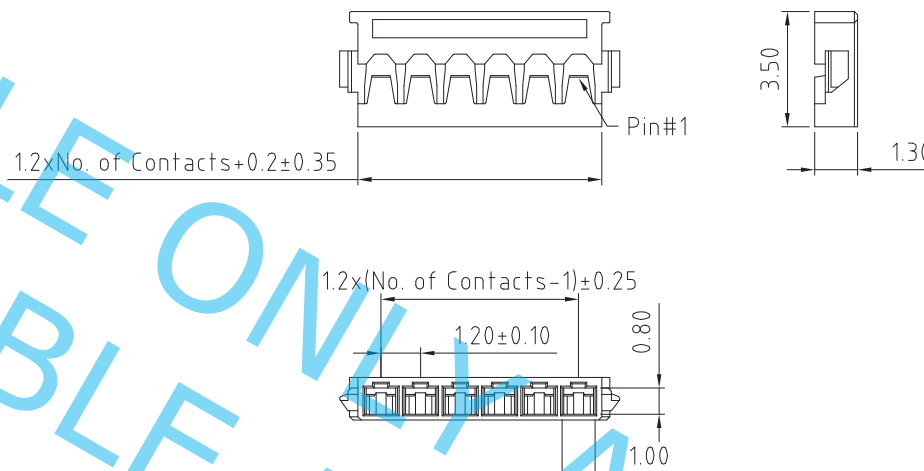
MATES WITH: (WAFER) WB06-DA
(TERMINAL) WB06-DB-T

HOW TO ORDER

WB06 - DBXX2 K

NO. OF CONTACTS:
02 TO 06INSULATOR COLOR:
K = BLACK (STANDARD)

Scale: 6:1

Drawn: NYW

App'd: XXXX

Date: 11 FEB. '15

THIRD ANGLE

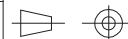

Title FEMALE HOUSING

Revision: 1.0

Unstated Tolerances:

.X ±0.35
.XX ±0.25
.XXX ±0.15

Material

SEE NOTE

NOT TO SCALE

Unit: mm

**Infratron**
www.infratron.de© THIS DRAWING IS CONFIDENTIAL AND MUST NOT BE
COPIED OR DISCLOSED WITHOUT WRITTEN CONSENT

Type: WB06-DB

WB06-DB

Drawing Number:

Sheet 1 of 1

Drawing ©

E and O E

WB06-DB-T :-1.20mm WTB FEMALE TERMINAL, AWG#28 TO 30

SPECIFICATIONS:

OPERATING TEMPERATURE: -25°C TO +85°C

APPLICATION WIRES: AWG#28 TO #30

MATERIAL: PHOSPHOR BRONZE

FINISH: GOLD FLASH PLATED OVER NICKEL

MATES WITH: (FEMALE HOUSING) WB06-DB

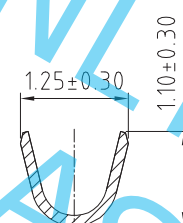
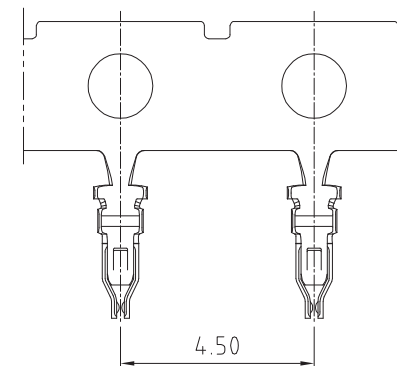
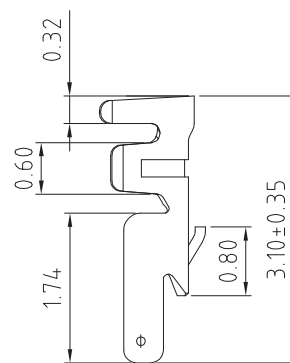
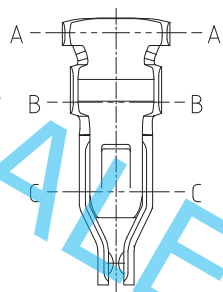

Section A - A

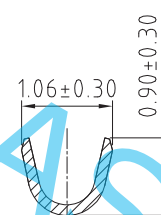

Section B - B

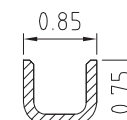

Section C - C

HOW TO ORDER

WB06 - DB - T - K

Plating Type.
K = Gold Flash

Scale: NTS

Drawn: NYW

App'd: XXXX

Date: 11 FEB. '15

THIRD ANGLE

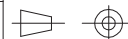

Title FEMALE TERMINAL

Revision: 1.0

Unstated Tolerances:

.X ±0.25
.XX ±0.15
.XXX ±0.05

Material

SEE NOTE

NOT TO SCALE

Unit: mm

**Infratron**
www.infratron.deTHIS DRAWING IS CONFIDENTIAL AND MUST NOT BE
COPIED OR DISCLOSED WITHOUT WRITTEN CONSENT

Type: WB06-DB-T

WB06-DB-T

Drawing Number:

Sheet 1 of 1

Drawing ©

E and O E