

BB02-BE

## CUSTOMER PRODUCT SPECIFICATION SHEET

RoHS  
Compliant

BB02-BE :- 1.27mm X 1.27mm (0.05" X 0.05") BOX HEADER, THROUGH HOLE, DUAL ROW, STRAIGHT - 10 TO 100 CONTACTS

## SPECIFICATIONS :

CURRENT RATING	1 AMP
INSULATOR RESISTANCE	1000 MEGOHMS MIN.
DIELECTRIC WITHSTANDING	AC 300 V
CONTACT RESISTANCE	20m OHMS MAX.
OPERATING TEMPERATURE	-40°C TO +105°C
CONTACT MATERIAL	BRASS
INSULATOR MATERIAL	THERMOPLASTIC, UL 94V-0 STANDARD : NYLON 6T
PLATING	GOLD, TIN, OR SELECTIVE OVER 30~50U" NICKEL
SOLDERABILITY	IR REFLOW: 260°C FOR 10 SEC WAVE: 230°C FOR 5-10 SEC MANNUAL SOLDER: 350°C FOR 3-5 SEC

PACKED IN TRAY.

MATES WITH: BB02-CL BB02-CU  
BB02-CM  
BB02-CN  
BB02-CR

## NOTES:

## 1. MATING HEIGHTS:

- a). WITH INSULATION HEIGHT OF A=5.7MM, THE MATING HEIGHT IS 1.6MM+SOCKET HEIGHT.  
b). WITH INSULATION HEIGHT OF B=7.3MM, THE MATING HEIGHT IS 3.2MM+SOCKET HEIGHT.

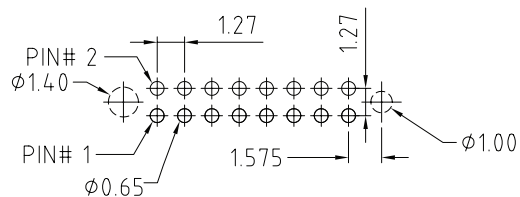
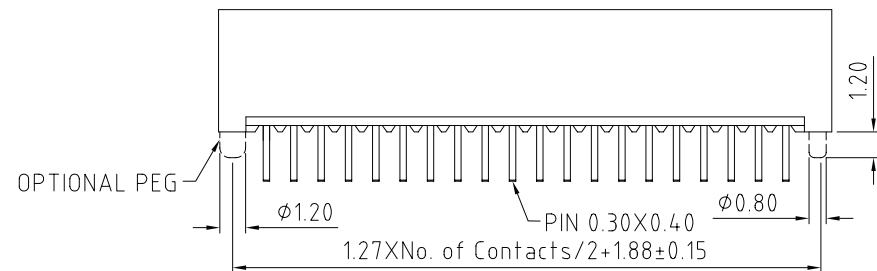
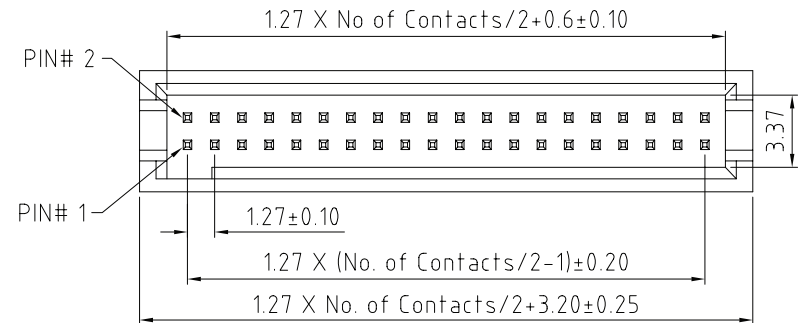
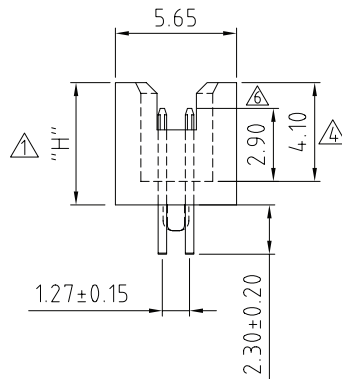
RECOMMENDED PC BOARD SMD LAYOUT  
(TOLERANCE: ±0.05)

## HOW TO ORDER

B B 0 2 - B E X X 1 - X X 2 - X 0 0 0 0 0

NO. OF CONTACTS  
10 TO 98  
100 Contacts = 00

## CONTACT PLATING OPTIONS

K = GOLD FLASH (STANDARD)  
A = 10U" GOLD ON CONTACT/GOLD FLASH ON TAIL  
B = 15U" GOLD ON CONTACT/GOLD FLASH ON TAIL  
C = 30U" GOLD ON CONTACT/GOLD FLASH ON TAIL  
T = BRIGHT TIN  
M = MATT TIN  
D = GOLD FLASH ON CONTACT/BRIGHT TIN ON TAIL  
E = 10U" GOLD ON CONTACT/BRIGHT TIN ON TAIL  
F = 15U" GOLD ON CONTACT/BRIGHT TIN ON TAIL  
G = 30U" GOLD ON CONTACT/BRIGHT TIN ON TAIL

"H" HEIGHT  
A = 5.70MM  
B = 7.30MM

WITH OR WITHOUT LOCATING  
PEG  
A = WITH  
B = WITHOUT

REV.	DATE & DRN
10	19/09/05 - CHC RELEASE
11	28/10/05 - NYW
12	ADD INSULATOR H OPTION. AMEND PLATING OPTIONS.
13	17/07/06 - NYW DRAWING MODIFICATION.
14	20/05/08 - CHC PLATING MODIFICATION.
15	14/08/08 - NYW ADD INSULATOR DIMENSION. ADD INSULATOR DIMENSION. ADD NOTES - CHC
16	02/12/08 - CHC ADD TOLERANCE
17	26/11/09 - NYW ADD DIMENSION

Scale: 4:1

Drawn: CHC

App'd: NYW

Date: 24 NOV '09

THIRD ANGLE

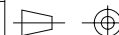

Title BOX HEADER

Revision: 1.6

Unstated Tolerances:  
X. ± 0.30  
X ± 0.25  
XX ± 0.15  
XXX ± 0.10

Material  
SEE NOTE

NOT TO SCALE

UNIT: mm



THIS DRAWING IS CONFIDENTIAL AND MUST NOT BE  
COPIED OR DISCLOSED WITHOUT WRITTEN CONSENT

Type: BB02-BE

BB02-BE

Drawing Number:

Sheet 1 of 1

Drawing © E and O E