

BB02-CE

CUSTOMER PRODUCT SPECIFICATION SHEET

RoHS
Compliant

BB02-CE :- 1.27mm SOCKET, SINGLE ROW, STRAIGHT, THROUGH HOLE, 3 - 35 CONTACTS. PROFILE: 8.5MM

SPECIFICATIONS

CURRENT RATING	1 AMP
INSULATOR RESISTANCE	1000 MEGOHMS MIN.
CONTACT RESISTANCE	20m ohms MAX.
DIELECTRIC WITHSTANDING	AC 300 V
OPERATING TEMPERATURE	-40°C TO +105°C
CONTACT MATERIAL	PHOSPHOR BRONZE
INSULATOR MATERIAL	POLYESTER, UL 94V-0
	STANDARD: NYLON 6T
PLATING	GOLD, TIN OR SELECTIVE OVER 30~50U" NICKEL
SOLDERABILITY	IR REFLOW: 260°C FOR 10 SEC
	WAVE: 230°C FOR 5-10 SEC
	MANNUAL SOLDER: 350°C FOR 3-5 SEC

PACKED IN TUBE OR TRAY

NOTES:

1. RECOMMENDED MATING PIN LENGTH : 4.0MM Δ

MATES WITH :- (0.46MM SQUARE PINS)



BB02-BL BB02-NH
BB02-BM
BB02-NM

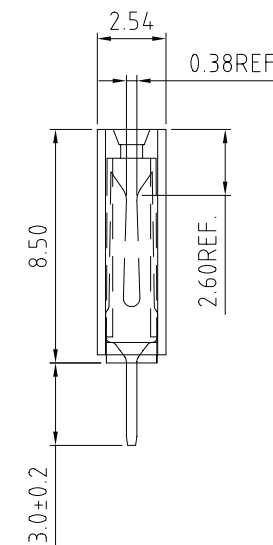
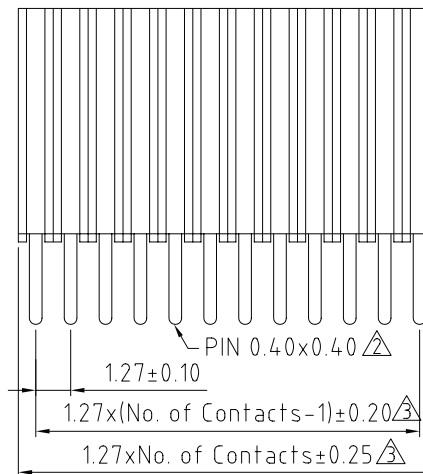
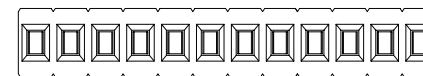

HOW TO ORDER

BB02 - CEXX2 - X03 - 300000

NO. OF CONTACTS
03 TO 35 Δ

CONTACT PLATING OPTIONS

K = GOLD FLASH (STANDARD)

A = 10U" GOLD ON CONTACT/GOLD FLASH ON TAIL

B = 15U" GOLD ON CONTACT/GOLD FLASH ON TAIL

C = 30U" GOLD ON CONTACT/GOLD FLASH ON TAIL

T = BRIGHT TIN

M = MATT TIN

D = GOLD FLASH ON CONTACT/BRIGHT TIN ON TAIL

E = 10U" GOLD ON CONTACT/BRIGHT TIN ON TAIL

F = 15U" GOLD ON CONTACT/BRIGHT TIN ON TAIL

G = 30U" GOLD ON CONTACT/BRIGHT TIN ON TAIL

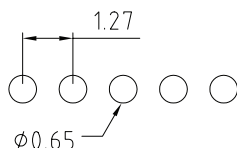
PIN LENGTH Δ RECOMMENDED PC BOARD HOLE LAYOUT Δ

REV.	DATE & DRN
10	06/06/02 - S/T RELEASE
11	11/02/05 - NYW DRAWING MODIFICATION
12	21/07/05 - NYW DRAWING MODIFICATION ADD CONTACTS AMEND PCB LAYOUT AMEND PIN DIMENSION
13	29/07/05 - NYW DIMENSION MODIFICATION
14	19/07/06 - NYW DRAWING MODIFICATION
15	05/06/07 - CHC ADD NOTES 1
16	05/05/08 - CHC DRAWING MODIFICATION AMEND MATES WITH
17	25/12/08 - CHC ADD TOLERANCE AMEND MATING PART

Scale:	5:1
Drawn:	CHC
App'd:	XXXX
Date:	25 DEC '08
THIRD ANGLE	
Title	SOCKET
Revision:	1.7
Material	SEE NOTE
UNIT:	mm

Unstated Tolerances:
X ± 0.30
X ± 0.25
XX ± 0.15
XXX ± 0.10



THIS DRAWING IS CONFIDENTIAL AND MUST NOT BE
COPIED OR DISCLOSED WITHOUT WRITTEN CONSENT

Type: BB02-CE

BB02-CE

Drawing Number:

Sheet 1 of 1

Drawing © E and O E