

BB02-CR

CUSTOMER PRODUCT SPECIFICATION SHEET

RoHS
Compliant

BB02-CR :- 1.27mm X 1.27mm (0.05" X 0.05") SMD SOCKET, DUAL ROW, STRAIGHT, 6 TO 100 CONTACTS, DUAL ENTRY

SPECIFICATIONS

CURRENT RATING	1 AMP
INSULATOR RESISTANCE	1000 MEGOHMS MIN.
CONTACTS RESISTANCE	20m OHMS MAX.
DIELECTRIC WITHSTANDING	AC 300 V
OPERATING TEMPERATURE	-40°C TO +105°C
CONTACT MATERIAL	PHOSPHOR BRONZE
INSULATOR MATERIAL	THERMOPLASTIC, UL 94V-0
(STANDARD: NYLON 6T FOR 6~50 CONTACTS, LCP+30% G/F FOR 52~100 CONTACTS)	
PLATING	GOLD OR TIN OVER MIN. 30U" NICKEL
SOLDERABILITY:	NYLON 6T - IR REFLOW: 260°C FOR 10 SEC
	MANUAL SOLDER: 350°C FOR 3-5 SEC
	LCP - IR REFLOW: 280°C FOR 10 SEC
	MANUAL SOLDER: 380°C FOR 3-5 SEC

NOTES:

1. RECOMMENDED MATING PIN LENGTH FROM TOP ENTRY IS 3.0MM

MATES WITH:- BB02-BC BB02-BS
BB02-BD BB02-BY
BB02-BE BB02-BZ
BB02-BK BB02-NE
BB02-BP

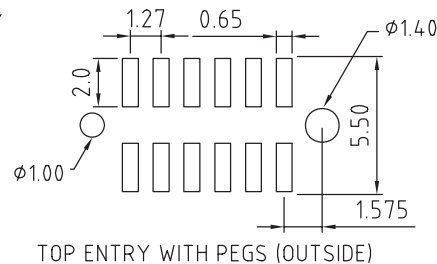

TOP ENTRY WITH PEGS (OUTSIDE)

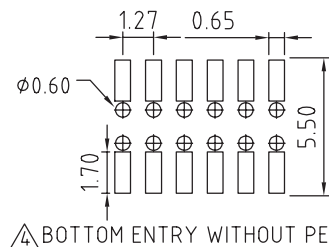

BOTTOM ENTRY WITHOUT PEGS

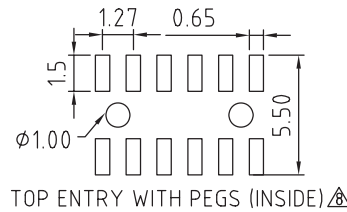

TOP ENTRY WITH PEGS (INSIDE)

RECOMMENDED PCB LAYOUT (TOLERANCE: ±0.05)

Film Width	
No. of Pins	Size
06 - 50	5mm
52 - 100	10mm

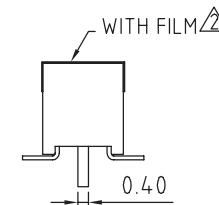
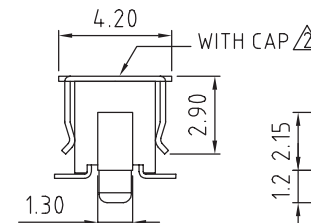
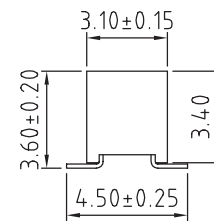

HOW TO ORDER

BB02 - CRXX2 - X0X - X00000

NO. OF CONTACTS :

06 TO 98
00 = 100

CONTACT PLATING OPTIONS :

K = GOLD FLASH (STANDARD)
A = 10U" GOLD ON CONTACT/GOLD FLASH ON TAIL
B = 15U" GOLD ON CONTACT/GOLD FLASH ON TAIL
C = 30U" GOLD ON CONTACT/GOLD FLASH ON TAIL
T = BRIGHT TIN
M = MATT TIN

PACKING OPTIONS :

3 = TUBE
4 = TUBE & FILM
5 = TUBE & CAP
6 = T+R
7 = T+R+FILM
8 = T+R+CAP

LOCATING PEGS OPTIONS :

A = WITH PEGS (OUTSIDE)
E = WITH PEGS (INSIDE)
0 = WITHOUT PEGS



Type: BB02-CR

BB02-CR

DRAWING NUMBER:

Sheet 1 of 1

Drawing © E and O E

REV. DATE & DRN
10 13/06/05 - NYW RELEASE
11 21/07/05 - NYW
12 04/11/05 - NYW
13 20/07/06 - NYW
14 05/06/07 - CHC
15 16/10/07 - CHC
16 27/05/08 - CHC
17 07/08/08 - CHC
18 23/08/11 - NYW
19 31/08/11 - NYW

Scale: 5:1	THIRD ANGLE	Unstated Tolerances: X ± 0.30 X ± 0.25 XX ± 0.15 XXX ± 0.10	Material SEE NOTE
Drawn: CHC	Title SOCKET		
App'd: XXXX	Revision: 1.9		
Date: 31 AUG '11		UNIT: mm	

THIS DRAWING IS CONFIDENTIAL AND MUST NOT BE
COPIED OR DISCLOSED WITHOUT WRITTEN CONSENT