

BB02-FB

CUSTOMER PRODUCT SPECIFICATION SHEET

RoHS
Compliant

BB02-FB :- 2.00mm (0.079") PIN HEADER, SINGLE ROW, THROUGH HOLE - 02 to 40 CONTACTS, STRAIGHT OR RIGHT ANGLE

SPECIFICATIONS :

CURRENT RATING 2 AMP Δ
INSULATOR RESISTANCE 1000 MEGOHMS MIN. Δ
DIELECTRIC WITHSTANDING AC 500 V
OPERATING TEMPERATURE -40°C TO +105°C
CONTACT MATERIAL BRASS
INSULATOR MATERIAL THERMOPLASTIC, UL 94V-0
NYLON 6T : STANDARD
PBT : SPECIAL OPTION
PLATING GOLD, TIN OR SELECTIVE OVER 30-50U" NICKEL
SOLDERABILITY: NYLON 6T - IR REFLOW: 260°C FOR 10 SEC
WAVE: 230°C FOR 5-10 SEC
MANUAL SOLDER: 350°C FOR 3-5 SEC
PBT - MANUAL SOLDER: 330°C FOR 3-5 SEC
(NOT SUITABLE FOR HI-TEMP PROCESS)

PACKED LOOSE IN BAG OR BOX Δ Δ

MATES WITH: BB02-GD BB02-RW
BB02-GS
BB02-RK
BB02-RS

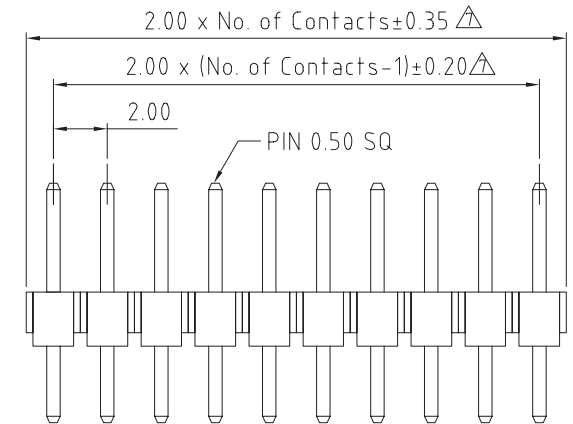
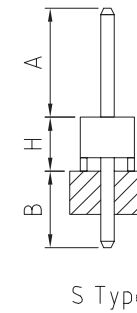
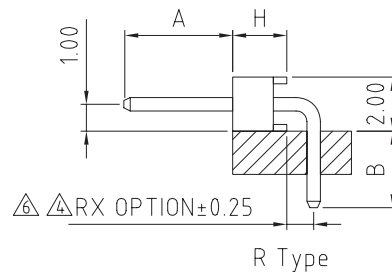

HOW TO ORDER

B B 0 2 - F B X X 1 - X X 1 - X X X X X X - 6 T

NO. OF CONTACTS
02 TO 40

CONTACT PLATING OPTIONS

K = GOLD FLASH (STANDARD)
A = 10U" GOLD ON CONTACT/GOLD FLASH ON TAIL
B = 15U" GOLD ON CONTACT/GOLD FLASH ON TAIL
C = 30U" GOLD ON CONTACT/GOLD FLASH ON TAIL
T = BRIGHT TIN
M = MATT TIN
D = GOLD FLASH ON CONTACT/TIN ON TAIL
E = 10U" GOLD ON CONTACT/TIN ON TAIL
F = 15U" GOLD ON CONTACT/TIN ON TAIL
G = 30U" GOLD ON CONTACT/TIN ON TAIL

HEIGHT H

A = 1.5mm
B = 2.0mm
STANDARD = B

PIN LENGTH B (1/10mm)

PLEASE SPECIFY PIN
LENGTH REQUIRED
I.E. 2.5mm = 25
STANDARD = 25
TOL. ±0.25mm

INSULATOR MATERIAL

6T = NYLON 6T (STANDARD)
BLANK = PBT (Not suitable for
new designs.)

PIN LENGTH A (1/10mm)

PLEASE SPECIFY PIN
LENGTH REQUIRED
I.E. 2.5mm = 25
STANDARD = 40
TOL. ±0.25mm

CONNECTOR TYPE

S0 = Straight
 Δ R0 = Right Angle 1.0mm (Standard)
R1 = Right Angle 0.25mm
 Δ R2 = Right Angle 1.27mm
 Δ R3 = Right Angle 1.50mm
(RX Custom length available.)

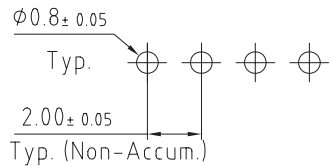

RECOMMENDED PCB LAYOUT
(TOLERANCE: ±0.05)

REV.	DATE & DRN
10	06/06/02 - S-JT RELEASE
11	21/07/04 - NYW
12	26/02/05 - NYW
13	03/08/06 - NYW
14	04/10/06 - NYW
15	28/05/07 - NYW
16	21/03/08 - CHC
17	03/09/08 - NYW
18	30/07/08 - CHC
19	12/11/09 - NYW
20	ADD R3 OPTION

Scale:	5:1	THIRD ANGLE	Unstated Tolerances:	Material
Drawn:	CHC		X: ± 0.30 X: ± 0.25 .XX: ± 0.15 .XXX: ± 0.10	SEE NOTE
App'd:	XXXX	Title	PIN HEADER	NOT TO SCALE
Date:	12 NOV '09	Revision:	1.9	Unit: mm



THIS DRAWING IS CONFIDENTIAL AND MUST NOT BE
COPIED OR DISCLOSED WITHOUT WRITTEN CONSENT

Type:	BB02-FB
	BB02-FB
Drawing Number:	
Sheet 1	of 1
Drawing	E and O E