

BB02-HA

CUSTOMER PRODUCT SPECIFICATION SHEET

RoHS
Compliant

BB02-HA :- 2.54mm (0.1") PIN HEADER, SINGLE ROW, THROUGH HOLE 02 TO 40 CONTACTS

SPECIFICATIONS

CURRENT RATING	3 AMP
INSULATOR RESISTANCE	1000 MEGOHMS MIN.
DIELECTRIC WITHSTANDING	AC 600 V
OPERATING TEMPERATURE	-40°C TO 105°C
CONTACT MATERIAL	BRASS
INSULATOR MATERIAL	THERMOPLASTIC, UL 94V-0 NYLON 6T : STANDARD PBT : SPECIAL OPTION
PLATING	GOLD, TIN OR SELECTIVE OVER 30-50U" NICKEL
SOLDERABILITY:	NYLON 6T - IR REFLOW: 260°C FOR 10 SEC WAVE: 230°C FOR 5-10 SEC MANNUAL SOLDER: 350°C FOR 3-5 SEC PBT - MANNUAL SOLDER: 330°C FOR 3-5 SEC (NOT SUITABLE FOR HI-TEMP PROCESS)

PACKED LOOSE IN BAG. OR BOX.

MATES WITH :- BB02-JB BB02-JL
BB02-JC BB02-JR
BB02-JD BB02-JS
BB02-JE BB02-JT
BB02-JF BB02-KR
BB02-JG
BB02-JJ

HOW TO ORDER

B B 0 2 - H A X X 1 - X B 1 - X X X X X X - 6 T

NO. OF CONTACTS
02 TO 40

CONTACT PLATING OPTIONS

K = GOLD FLASH (STANDARD)
A = 10U" GOLD ON CONTACT/GOLD FLASH ON TAIL
B = 15U" GOLD ON CONTACT/GOLD FLASH ON TAIL
C = 30U" GOLD ON CONTACT/GOLD FLASH ON TAIL
T = BRIGHT TIN
M = MATT TIN
D = GOLD FLASH ON CONTACT/BRIGHT TIN ON TAIL
E = 10U" GOLD ON CONTACT/BRIGHT TIN ON TAIL
F = 15U" GOLD ON CONTACT/BRIGHT TIN ON TAIL
G = 30U" GOLD ON CONTACT/BRIGHT TIN ON TAIL

PIN LENGTH A (1/10mm)
PLEASE SPECIFY PIN
LENGTH REQUIRED
I.E. 2.5mm = 25
STANDARD = 60

PIN LENGTH B (1/10mm)
PLEASE SPECIFY PIN
LENGTH REQUIRED
I.E. 2.5mm = 25
STANDARD = 30

CONNECTOR TYPE

S0 = STRAIGHT
U1 = UP ANGLE 4.8mm
U2 = UP ANGLE 6.0mm
U3 = UP ANGLE 6.6mm
U4 = UP ANGLE 2.86mm
U5 = UP ANGLE 3.3mm
U6 = UP ANGLE 8.5mm
D1 = DOWN ANGLE 1.5mm
D2 = DOWN ANGLE 2.0mm
D3 = DOWN ANGLE 0.32mm
D4 = DOWN ANGLE 1.0mm

INSULATOR MATERIAL
6T = NYLON 6T (STANDARD)
BLANK = PBT (Not suitable for new designs.)

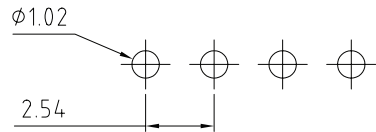

RECOMMENDED PCB HOLE LAYOUT
(TOLERANCE: ±0.05)

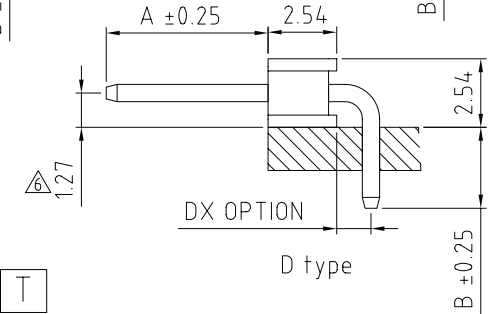
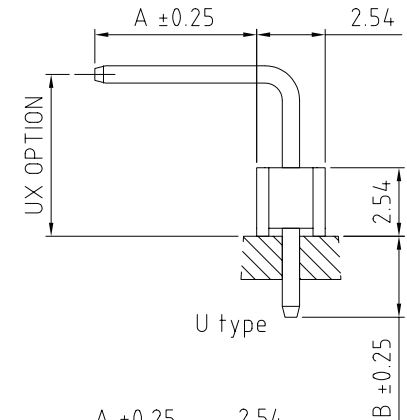
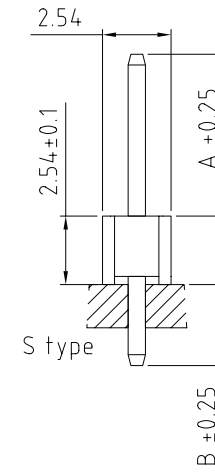
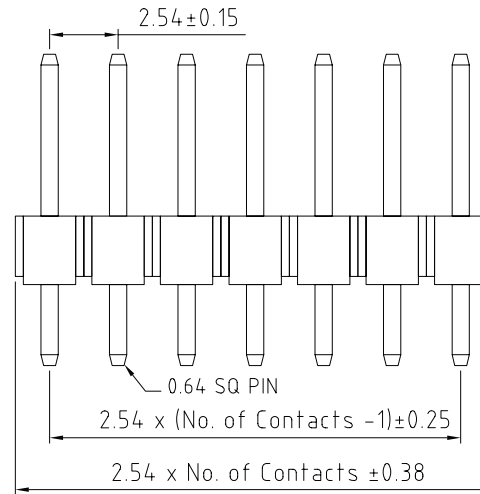

REV.	DATE & DRN
10	29/06/02 - SJT NEW
11	03/02/04 - NJR
12	23/08/04 - NYW
13	25/07/05 - NYW
14	16/08/05 - NYW
15	25/02/08 - NYW
16	29/08/08 - NYW
17	06/02/09 - CHC
18	19/06/09 - NYW

Scale:	5:1
Drawn:	CHC
App'd:	XXXX
Date:	19 JUN '09
THIRD ANGLE	
Title	PIN HEADER
Revision:	1.8

Material	SEE NOTE
NOT TO SCALE	
Unit:	mm



Type:	BB02-HA
Drawing Number:	BB02-HA
Sheet 1	of 1
Drawing	E and O E