

BB02-HC

CUSTOMER PRODUCT SPECIFICATION SHEET

RoHS
Compliant

BB02-HC :- 2.54mm (0.1") PIN HEADER, SINGLE ROW, STRAIGHT, THROUGH HOLE, LOW PROFILE 02 to 40 CONTACTS

SPECIFICATIONS

CURRENT RATING 3 AMP
INSULATOR RESISTANCE 1000 MEGOHMS MIN.
DIELECTRIC WITHSTANDING AC 600 V
OPERATING TEMPERATURE -40°C TO +105°C
CONTACT MATERIAL BRASS
INSULATOR MATERIAL POLYESTER UL 94V-0
STANDARD NYLON 6T Δ
PLATING GOLD, TIN, OR SELECTIVE OVER 30~50U" NICKEL
SOLDERABILITY: IR REFLOW: 260°C FOR 10 SEC
WAVE: 230°C FOR 5-10 SEC
MANUAL SOLDER: 350°C FOR 3-5 SEC

PACKED LOOSE IN BAG OR BOX.

MATES WITH :- BB02-JB BB02-JL
BB02-JC BB02-JR
BB02-JD BB02-JS
BB02-JE BB02-JT
BB02-JF BB02-KR
BB02-JG
BB02-JJ

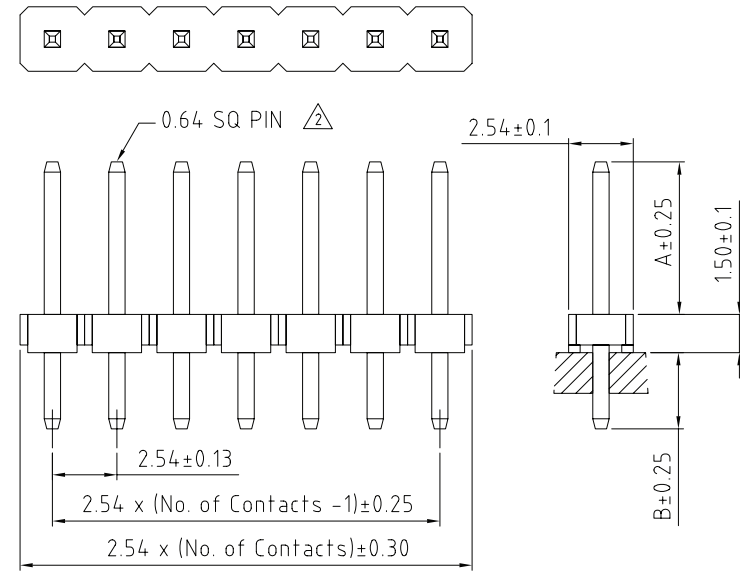

HOW TO ORDER

B B 0 2 - H C X X 1 - X B 1 - X X X X 0 0 - 6 T

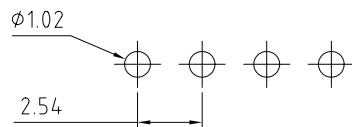
RECOMMENDED PC BOARD HOLE LAYOUT
(TOLERANCE: ± 0.05) Δ NO. OF
CONTACTS
02 TO 40

CONTACT PLATING OPTIONS
K = GOLD FLASH (STANDARD)
A = 10U" GOLD ON CONTACT/GOLD FLASH ON TAIL
B = 15U" GOLD ON CONTACT/GOLD FLASH ON TAIL
C = 30U" GOLD ON CONTACT/GOLD FLASH ON TAIL
T = BRIGHT TIN
M = MATT TIN
D = GOLD FLASH ON CONTACT/BRIGHT TIN ON TAIL
E = 10U" GOLD ON CONTACT/BRIGHT TIN ON TAIL
F = 15U" GOLD ON CONTACT/BRIGHT TIN ON TAIL
G = 30U" GOLD ON CONTACT/BRIGHT TIN ON TAIL

PIN LENGTH A (1/10mm)
PLEASE SPECIFY PIN
LENGTH REQUIRED
I.E. 2.5mm = 25
STANDARD = 60

PIN LENGTH B (1/10mm)
PLEASE SPECIFY PIN
LENGTH REQUIRED
I.E. 2.5mm = 25
STANDARD = 30

REV	DATE & DRN
10	06/05/03 - N/R RELEASE
11	23/08/04 - CHC
12	REMOVE PIN OPTION A
13	REMOVE PIN OPTION 3
14	ADD PIN DIA.
15	ADD TOLERANCE.
16	ADD PLASTIC OPTION
17	REMOVE PIN MATERIAL C
18	CHANGE STANDARD PLASTIC
19	MATERIAL TO NYLON 6T
20	CHANGE MAX. PINH 32 TO 40
21	04/06/08 - NYW
22	PLATING MODIFICATION
23	06/07/09 - CHC
24	DRAWING MODIFICATION

Scale:	5:1
Drawn:	CHC
App'd:	XXX
Date:	6 FEB '09
THIRD ANGLE	
Title:	PIN HEADER
Revision:	1.7

Unstated Tolerances:
X ± 0.30
.X ± 0.25
.XX ± 0.15
.XXX ± 0.10

Material	SEE NOTE
NOT TO SCALE	
Unit	mm

© THIS DRAWING IS CONFIDENTIAL AND MUST NOT BE
COPIED OR DISCLOSED WITHOUT WRITTEN CONSENT

Type:	BB02-HC
Drawing Number:	BB02-HC
Sheet	1 of 1
Drawing	© E and O E