

BB02-JT : -2.54mm (0.1") SOCKET, STRAIGHT, THROUGH HOLE, SINGLE ROW - 02 to 40 CONTACTS

SPECIFICATIONS

CURRENT RATING	3 AMP
INSULATOR RESISTANCE	1000 MEGOHMS MIN.
CONTACT RESISTANCE	20m ohms MAX.
DIELECTRIC WITHSTANDING	AC 600 V
OPERATING TEMPREATURE	-40°C TO +105°C
CONTACT MATERIAL	PHOSPHOR BRONZE
INSULATOR MATERIAL	THERMOPLASTIC, UL 94V-0
	STANDARD NYLON 6T
PLATING	GOLD, SELECTIVE, OR TIN OVER 30-50U" NICKEL
SOLDERABILITY	IR REFLOW: 260°C FOR 10 SEC
	WAVE: 230°C FOR 5-10 SEC
	MANUAL SOLDER: 350°C FOR 3-5 SEC

PACKED IN TUBE OR BOX.

MATES WITH:

BB02-HA	BB02-HY	BB02-TK
BB02-HC	BB02-HZ	
BB02-HD	BB02-TA	
BB02-HG	BB02-TC	
BB02-HH	BB02-TJ	

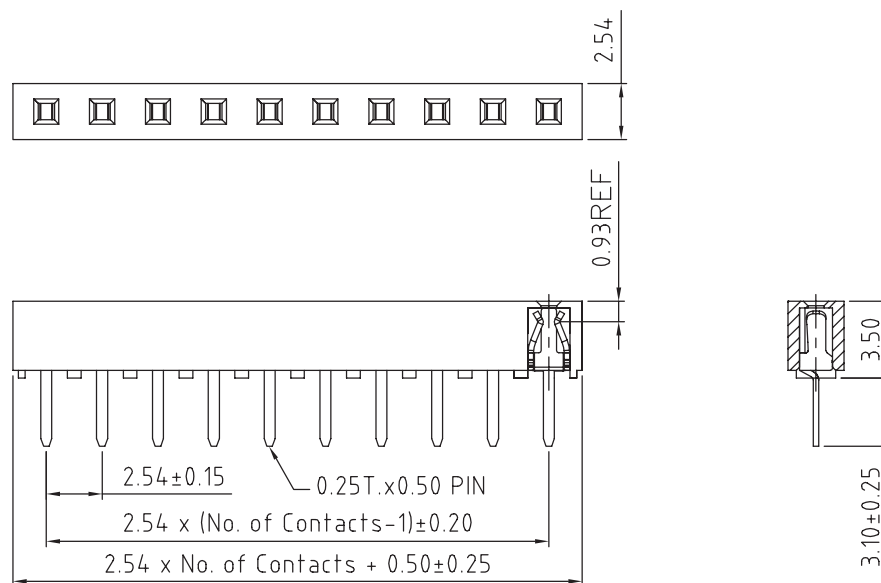

NOTES:

1. RECOMMENDED MATING PIN LENGTH: 2.5MM.

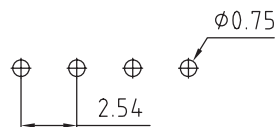

(Tolerance: ± 0.05)

RECOMMENDED PC BOARD HOLE LAYOUT

HOW TO ORDER



NO. OF CONTACTS
02 TO 40

CONTACT PLATING OPTIONS

K = GOLD FLASH (STANDARD)

A = 10U" GOLD ON CONTACT/GOLD FLASH ON TAIL

B = 15U" GOLD ON CONTACT/GOLD FLASH ON TAIL

C = 30U" GOLD ON CONTACT/GOLD FLASH ON TAIL

T = BRIGHT TIN

M = MATT TIN

D = GOLD FLASH ON CONTACT/BRIGHT TIN ON TAIL

E = 10U" GOLD ON CONTACT/BRIGHT TIN ON TAIL

F = 15U" GOLD ON CONTACT/BRIGHT TIN ON TAIL

G = 30U" GOLD ON CONTACT/BRIGHT TIN ON TAIL