

BB02-KU

## CUSTOMER PRODUCT SPECIFICATION SHEET

RoHS  
Compliant

BB02-KU :- 2.54mm X 2.54mm (0.1" X 0.1") SMD FEMALE HEADER, DUAL ROW - 06 TO 80 CONTACTS, DUAL ENTRY

## SPECIFICATIONS

CURRENT RATING	3 AMPS
INSULATOR RESISTANCE	1000 MEGOHMS MIN.
CONTACT RESISTANCE	20m OHMS MAX
DIELECTRIC WITHSTANDING	AC 600 V
OPERATING TEMPERATURE	-40°C TO +105°C
CONTACT MATERIAL	PHOSPHOR BRONZE
INSULATOR MATERIAL	THERMOPLASTIC, UL 94V-0
	STANDARD NYLON-6T
PLATING	GOLD, TIN OR SELECTIVE OVER 30~50U" NICKEL
SOLDERABILITY	IR REFLOW: 260°C FOR 10 SEC
	MANNUAL SOLDER: 350°C FOR 3-5 SEC

MATES WITH:	BB02-HE	BB02-HQ	BB02-TF
	BB02-HF	BB02-HR	BB02-TG
	BB02-HJ	BB02-HU	BB02-TH
	BB02-HP	BB02-TD	

## NOTES:

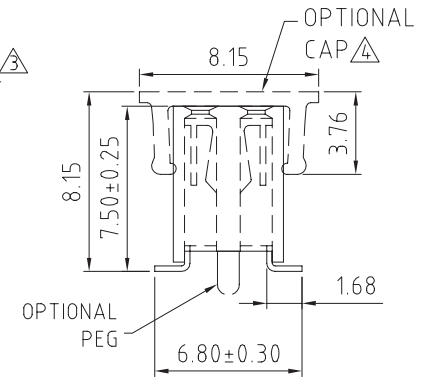
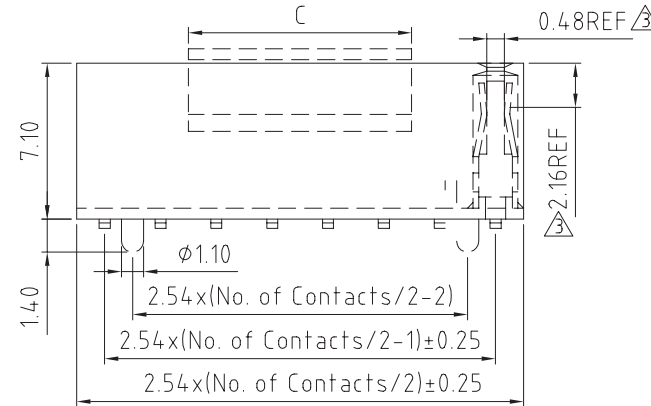
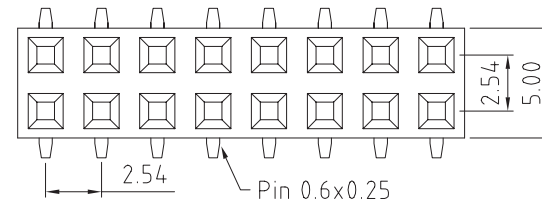
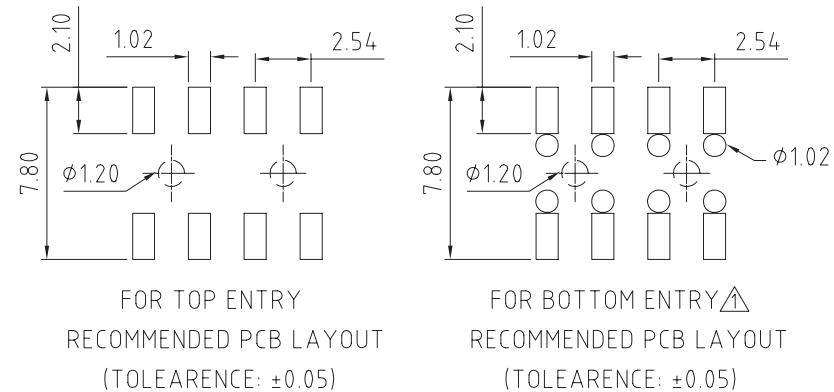
1. RECOMMENDED MATING PIN LENGTH FOR TOP ENTRY: 4.5MM.  $\Delta$ 

## HOW TO ORDER

B	B	0	2	-	K	U	X	X	2	-	X	0	X	-	X	0	0	0	0	0
---	---	---	---	---	---	---	---	---	---	---	---	---	---	---	---	---	---	---	---	---

NO. OF  
CONTACTS  
06 TO 80

## CONTACT PLATING OPTIONS

K = GOLD FLASH (STANDARD)

A = 10U" GOLD ON CONTACT/GOLD FLASH ON TAIL

B = 15U" GOLD ON CONTACT/GOLD FLASH ON TAIL

C = 30U" GOLD ON CONTACT/GOLD FLASH ON TAIL

T = BRIGHT TIN

M = MATT TIN

D = GOLD FLASH ON CONTACT/BRIGHT TIN ON TAIL

E = 10U" GOLD ON CONTACT/BRIGHT TIN ON TAIL

F = 15U" GOLD ON CONTACT/BRIGHT TIN ON TAIL

G = 30U" GOLD ON CONTACT/BRIGHT TIN ON TAIL

## PACKAGING OPTIONS

3 - TUBE

4 - TUBE &amp; FILM

5 - TUBE &amp; CAP

6 - T &amp; R

7 - T &amp; R &amp; FILM

8 - T &amp; R &amp; CAP

## LOCATING PEG OPTION

A = WITH PEG

B = WITHOUT PEG

REV.	DATE & DRN
15	06/05/15 - NYW RELEASE
14	05/12/15 - NYW
13	05/12/15 - NYW
12	09/08/16 - CHC
11	09/05/17 - NYW
10	09/05/17 - NYW
9	09/05/17 - NYW
8	09/05/17 - NYW
7	09/05/17 - NYW
6	09/05/17 - NYW
5	09/05/17 - NYW
4	09/05/17 - NYW
3	09/05/17 - NYW
2	09/05/17 - NYW
1	09/05/17 - NYW

Scale: 4:1

Drawn: CHC

App'd: XXXX

Date: 04 FEB '09

THIRD ANGLE

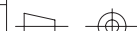

Title SOCKET

Revision: 1.6

Unstated Tolerances:

X: ± 0.30

X: ± 0.25

XX: ± 0.15

XXX: ± 0.10

Material

SEE NOTE

NOT TO SCALE

Unit: mm

THIS DRAWING IS CONFIDENTIAL AND MUST NOT BE  
COPIED OR DISCLOSED WITHOUT WRITTEN CONSENT

Type: BB02-KU

BB02-KU

Drawing Number:

Sheet 1 of 1

Drawing C

E and O E