

BB02-TH

CUSTOMER PRODUCT SPECIFICATION SHEET

RoHS
Compliant

BB02-TH :- 2.54mm x 2.54mm (0.1" x 0.1") PIN HEADER, DUAL ROW, RIGHT ANGLE, SMT - 04 to 80 CONTACTS

SPECIFICATIONS

CURRENT RATING	3 AMP
VOLTAGE RATING	250V AC/DC
CONTACT RESISTANCE	20m OHM MAX.
INSULATOR RESISTANCE	1000 MEGOHMS MIN.
DIELECTRIC WITHSTANDING	AC 550 V
OPERATING TEMPERATURE	-25°C TO +105°C
CONTACT MATERIAL	BRASS
INSULATOR MATERIAL	THERMOPLASTIC, UL 94V-0 STANDARD: NYLON 6T.
PLATING	GOLD, TIN, OR SELECTIVE OVER 30-50U" NICKEL
SOLDERABILITY:	IR REFLOW: 260°C FOR 10 SEC MANUAL SOLDER: 350°C FOR 3-5 SEC

MATES WITH :-	BB02-JM	BB02-KH	BB02-KU
	BB02-KA	BB02-KK	BB02-KW
	BB02-KD	BB02-KM	BB02-LD
	BB02-KF	BB02-KS	BB02-LE
	BB02-KG	BB02-KT	

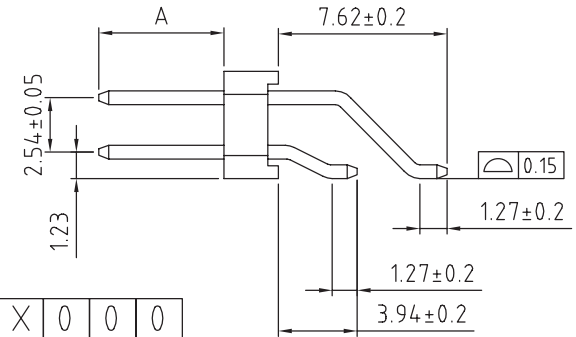
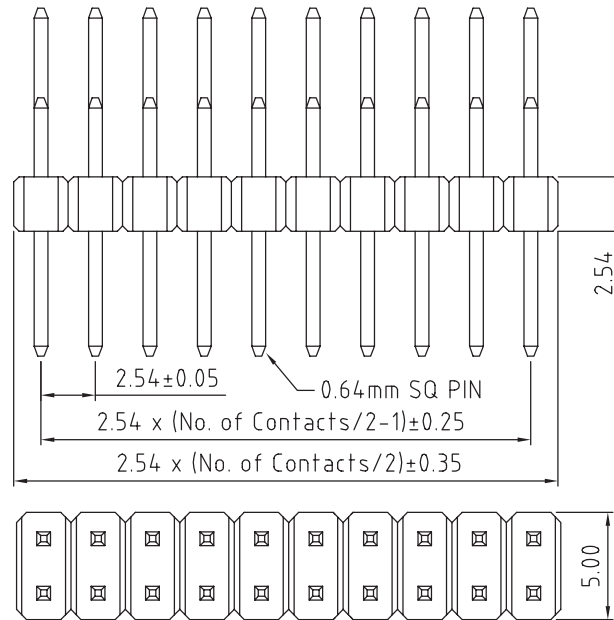

HOW TO ORDER

B B 0 2 - T H X X 1 - X 0 X - X X X 0 0 0

CONTACT PLATING OPTIONS

K = GOLD FLASH (STANDARD)
A = 10U" GOLD ON CONTACT/GOLD FLASH ON TAIL
B = 15U" GOLD ON CONTACT/GOLD FLASH ON TAIL
C = 30U" GOLD ON CONTACT/GOLD FLASH ON TAIL
T = BRIGHT TIN
M = MATT TIN
D = GOLD FLASH ON CONTACT/BRIGHT TIN ON TAIL
E = 10U" GOLD ON CONTACT/BRIGHT TIN ON TAIL
F = 15U" GOLD ON CONTACT/BRIGHT TIN ON TAIL
G = 30U" GOLD ON CONTACT/BRIGHT TIN ON TAIL

PACKAGING OPTIONS

3 - TUBE
5 - TUBE & CAP
8 - T & R & CAP

PIN LENGTH A (1/10mm)

SPECIFY PIN LENGTH
STANDARD = 058 = 5.8mm
MINIMUM = 010 = 1.0mm
MAXIMUM = 150 = 15.0mm
TOL.: ±0.25mm

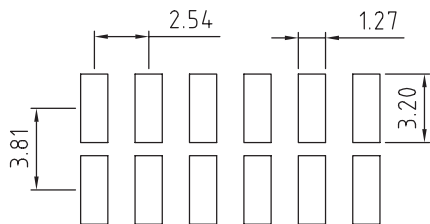

(Tolerance: ±0.05)
RECOMMENDED PCB LAYOUT

NO. OF
CONTACTS
04 TO 80

REV. DATE & DRN
1.0 05/06/10 - NYW RELEASE

Scale: 4:1

Drawn: NYW

App'd: XXX

Date: 5 JUN '10

THIRD ANGLE

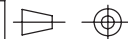

Title PIN HEADER

Revision: 1.0

Unstated Tolerances:
X ± 0.30
X ± 0.25
.XX ± 0.15
.XXX ± 0.10

Material
SEE NOTE

NOT TO SCALE

Unit mm



THIS DRAWING IS CONFIDENTIAL AND MUST NOT BE
COPIED OR DISCLOSED WITHOUT WRITTEN CONSENT

Type: BB02-TH

BB02-TH

Drawing Number:

Sheet 1 of 1

Drawing © E and O E