

BB02-YN

CUSTOMER PRODUCT SPECIFICATION SHEET

RoHS
Compliant

BB02-YN :- 1.0mm (0.039") SMD PIN HEADER, SINGLE ROW, R/A - 02 TO 40 CONTACTS

SPECIFICATIONS :

CURRENT RATING	1 AMP
INSULATOR RESISTANCE	1000 MEGOHMS MIN.
CONTACTS RESISTANCE	20 m OHMS MAX.
DIELECTRIC WITHSTANDING	AC 300V
OPERATING TEMPERATURE	-40°C TO +105°C
CONTACT MATERIAL	PHOSPHOR BRONZE
INSULATOR MATERIAL	THERMOPLASTIC, UL 94V-0
	STANDARD: LCP+30%G/F OR EQUIVALENT
PLATING	GOLD, TIN, OR SELECTIVE OVER 30-50U" NICKEL
SOLDERABILITY	IR REFLOW: 280°C FOR 10 SEC
	MANNUAL SOLDER: 380°C FOR 3-5 SEC

NOTES:

1. THE PACKAGING OPTION OF 02 TO 04 CONTACTS IS BOX.

MATES WITH :- BB02-WD

BB02-WE

BB02-WF

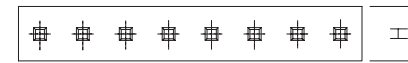
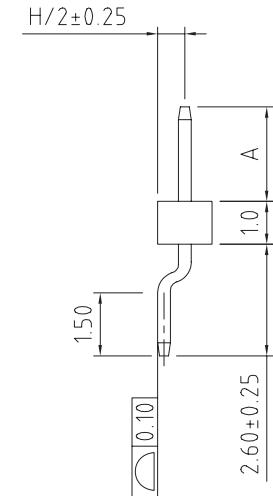
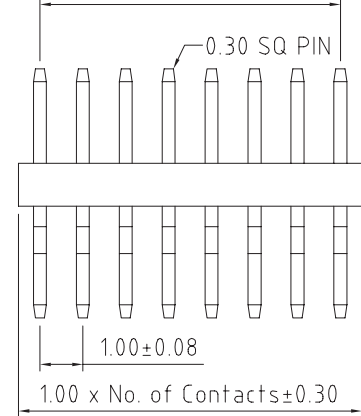
 $1.00 \times (\text{No. of Contacts} - 1) \pm 0.25$ 

HOW TO ORDER

BB02 - YNXX1 - XXX - XXX0000

NO. OF CONTACTS
02 TO 40

CONTACT PLATING OPTIONS

K = GOLD FLASH (STANDARD)
A = 10U" GOLD ON CONTACT/GOLD FLASH ON TAIL
B = 15U" GOLD ON CONTACT/GOLD FLASH ON TAIL
C = 30U" GOLD ON CONTACT/GOLD FLASH ON TAIL
T = BRIGHT TIN
M = MATT TIN
D = GOLD FLASH ON CONTACT/BRIGHT TIN ON TAIL
E = 10U" GOLD ON CONTACT/BRIGHT TIN ON TAIL
F = 15U" GOLD ON CONTACT/BRIGHT TIN ON TAIL
G = 30U" GOLD ON CONTACT/BRIGHT TIN ON TAIL

HEIGHT H OPTIONS:

A = 1.27MM
B = 1.50MM

PACKAGING OPTIONS:

3 - TUBE (SEE NOTE.1)
6 - T & R
7 - T & R + FILM

PIN LENGTH 'A' (1/10mm)
PLEASE SPECIFY PIN
LENGTH REQUIRED IN mm
I.E. 2.5mm = 25
STANDARD = 1.5
TOL. ±0.25mm

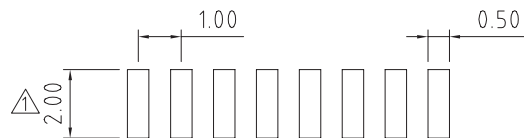
RECOMMENDED PC BOARD SMD LAYOUT
(TOLERANCE: ±0.05)

REV. DATE & DRN	10 03/07/09 - CHC RELEASE	Scale: 8:1	THIRD ANGLE	Unstated Tolerances: X ± 0.30 X ± 0.25 XX ± 0.15 XXX ± 0.10	Material SEE NOTE		Type: BB02-YN
11 14/10/09 - NYM	AMEND SPECIFICATION	Drawn: CHC					BB02-YN
12 02/12/09 - NYM	REMOVE OPTION 2 & 3 FROM HEIGHT C	App'd: XXX	Title PIN HEADER		NOT TO SCALE		Drawing Number:
13 17/12/09 - NYM	ADD B HEIGHT OPTION	Date: 17 DEC '10	Revision: 1.4	UNIT: mm			Sheet 1 of 1
14 17/12/10 - NYM	REMOVE HEIGHT C OPTION						Drawing © E and O E