

## CH03-AA-A: SIM CARD CONNECTOR SMT, SLIDE IN TYPE, 6 OR 8 CONTACTS, WITH SWITCH

## FEATURES

## 1. GENERAL CHARACTERISTICS

CONTACT PRINCIPLE: FRICTION TECHNOLOGY

MOUNTING SYSTEM: SMT TYPE

DURABILITY: 10,000 CYCLES MIN.

## 2. MECHANICAL CHARACTERISTICS

INSULATION MATERIAL: THERMOPLASTIC, UL 94V-0

CONTACT MATERIAL: PHOSPHOR BRONZE

CONTACT PLATING: GOLD OR PD OVER NICKEL

## 3. ELECTRICAL CHARACTERISTICS

CARD DETECTING SWITCH STATE: NORMALLY OPEN

CONTACT RESISTANCE: 50M OHMS TYPICAL, 100M OHMS MAX.

INSULATION RESISTANCE: &gt; 1000M OHMS MIN. / 500V DC

RATED CURRENT: 0.5A MAX.

RATED VOLTAGE: 30V AC

WITHSTANDING DIELECTRIC VOLTAGE: 500V AC RMS FOR 1 MINUTE

## 4. SOLDERABILITY

VAPOR PHASE: 215°C FOR 30 SEC. MAX.

IR REFLOW: 260°C FOR 10 SEC.

MANUAL SOLDERING: 360°C FOR 3 SEC. MAX.

## 5. ENVIRONMENTAL CHARACTERISTICS

OPERATING TEMP.: -40°C~+85°C

OPERATING HUMIDITY: 10%~95% RH

STORAGE TEMP.: -40°C~+85°C

STORAGE HUMIDITY: 10%~95% RH

DAMP HEAT: 40°C, 90% RH, 500HR

SALT- MIST: 35°C, 5%, NaCl, 48H

## NOTES:

1. ACCEPTABLE SIM CARD SIZE SHOULD MEET GSM 11.11 SPECIFICATION REQUIREMENT. ⚠

2. IF USING IN A HIGH TEMPERATURE ENVIRONMENT PLEASE CHECK WITH GRADCONN. ⚠

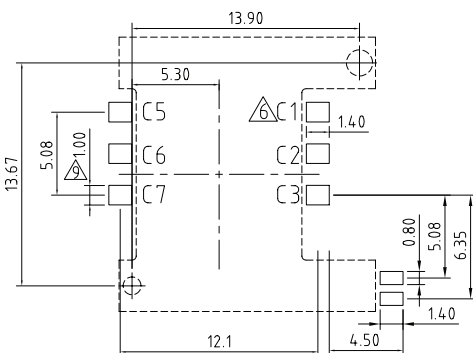
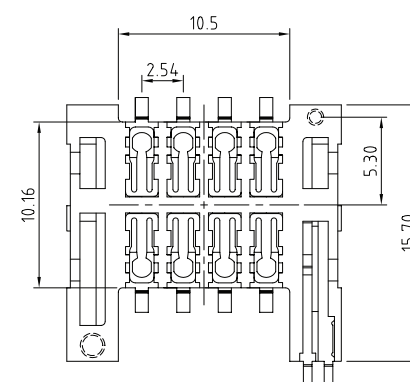
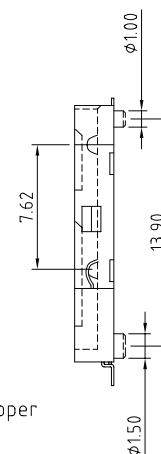
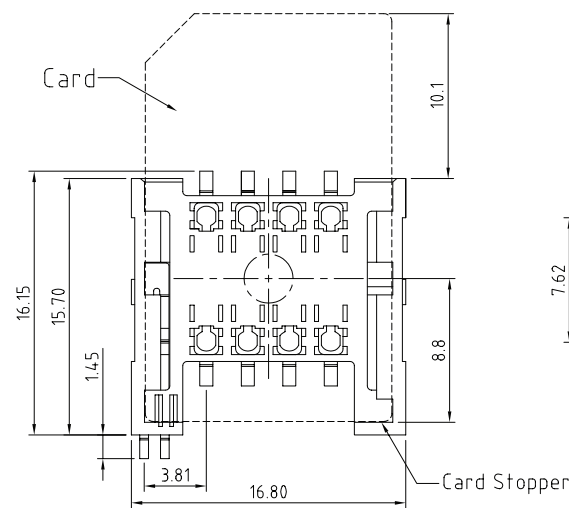
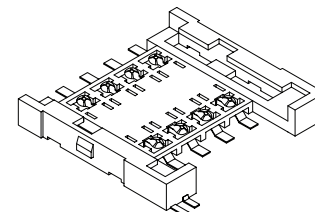
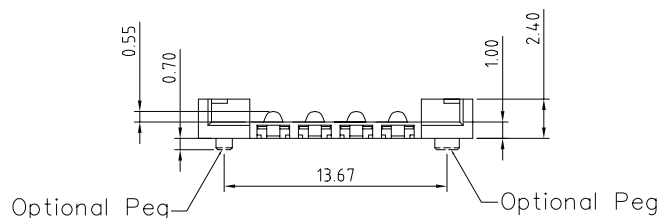

6 PINS VERSION

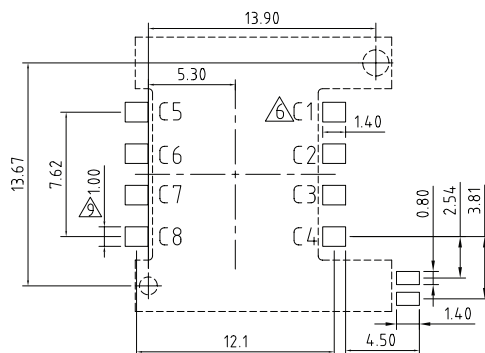

8 PINS VERSION

RECOMMENDED PCB LAYOUT

## HOW TO ORDER

C H 0 3 - A A X X 0 - A X X - L

NO. OF CONTACTS  
06 (STANDARD)  
OR  
08 (NON-STANDARD)

WITH SWITCH

WITH OR WITHOUT  
LOCATING PEG  
A = WITH (STANDARD)  
B = WITHOUT  
(NON-STANDARD)PACKAGING OPTIONS  
T = TUBE  
R = REEL ⚠

&lt;&lt;NOTE : NON-STANDARD PARTS WOULD REQUIER HIGHER MOQ.&gt;&gt;

REV. DATE & DRN	10 21/02/04-CHC RELEASE
11 22/07/05-NYW	AMEND PACK OPTION
12 21/03/06-NYW	ADD ROHS OPTION
13 11/07/08-NYW	REMOVE NON-ROHS VERSION
14 20/05/07-NYW	ADD NOTES 1.
15 22/08/07-NYW	ADD NOTES 2.
16 24/08/07-NYW	AMEND PIN LAYOUT#
17 20/11/07-NYW	SEPARATE PCB LAYOUT. MARK STANDARD AND NON-STANDARD OPTION.
18 03/06/08-NYW	ADD ELECTRICAL SPEC.
19 04/05/09-NYW	AMEND PCB PIN LAYOUT.

Scale: 3=1

Drawn: CHC

App'd: NYW

Date: 4 MAY '10

THIRD ANGLE

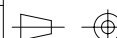

Title SIM CARD ACCEPTOR

Revision: 19

Unstated Tolerances:  
0 Dec Places  
1 Dec Places  
2 Dec Places  
3 Dec PlacesMaterial  
SEE NOTE

NOT TO SCALE

Unit: mm

© THIS DRAWING IS CONFIDENTIAL AND MUST NOT BE  
COPIED OR DISCLOSED WITHOUT WRITTEN CONSENT

Type: CH03-AA

CH03-AA-A

Drawing Number:

Sheet 1 of 1

Drawing C E and O E