

CH03-AB

CUSTOMER PRODUCT SPECIFICATION SHEET

RoHS
Compliant

CH03-AB - SIM CARD HOLDER WITH SWITCH 6 PINS, SLID IN TYPE, WITH HALF METAL COVER

FEATURES

1. GENERAL CHARACTERISTICS

DIMENSIONS: 15.85L x 16.50W x 3.00H mm

WEIGHT: APPROX. 0.70g

CONTACT PRINCIPLE: FRICTION TECHNOLOGY

OPERATING POSITION: SHAFT UP / DOWN / HORIZONTAL

MOUNTING SYSTEM: SMT TYPE WITHOUT POST

DURABILITY: 10,000 CYCLES MIN.

2. MECHANICAL CHARACTERISTICS

INSULATION MATERIAL: LCP+30% G.F, UL 94V-0

CONTACT MATERIAL: PHOSPHER BRONZE

PLATING :

DATA CONTACTS -

GOLD FLASH ON CONTACT AREA OVER 50U" NICKEL

GOLD FLASH ON SOLDER AREA (PCB SIDE) OVER 50U" NICKEL

50U" NICKEL ON THE REST.

CARD DETECTOR / SWITCH -

GOLD FLASH OVER 50U" NICKEL

METAL SHELL MATERIAL: STAINLESS STEEL

3. ELECTRICAL CHARACTERISTICS

CONTACT RESISTANCE: 50M OHMS TYP. 100M OHMS MAX.

INSULATION RESISTANCE: > 1000M OHMS / 500V DC

SWITCH TYPE: BLADE (Normally Open)

RATED CURRENT: 1A MAX.

RATED VOLTAGE: 50V MAX.

WITHSTANDING DIELECTRIC VOLTAGE: 50V AC R.M.S. FOR 1 MINUTE

4. SOLDERABILITY

WAVE: NOT APPLICABLE

IR REFLOW: 260°C, 10 SEC. MAX.

MANUAL SOLDERING: 360°C, 3 SEC. MAX.

5. ENVIRONMENTAL CHARACTERISTICS

OPERATING TEMPERATURE: -40°C ~ +85°C

OPERATING HUMIDITY: 10% ~ 95% RH

STORAGE TEMPERATURE: -40°C ~ +85°C

STORAGE HUMIDITY: 10% ~ 95% RH

THERMAL SHOCK: -40°C ~ +85°C, 5 CYCLES

DAMP HEAT: 40°C, 90% RH, 500HR

SALT-MIST: 35°C, 5% NaCl, 48HR

NOTES:

1. ACCEPTABLE SIM CARD SIZE SHOULD MEET GSM 11.11 SPECIFICATION REQUIREMENT.

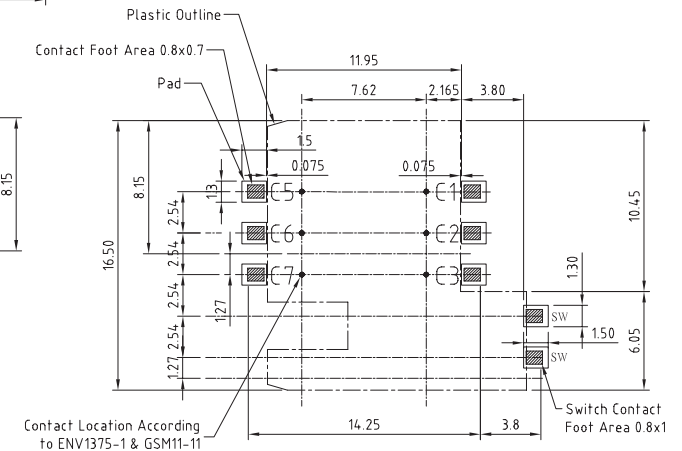
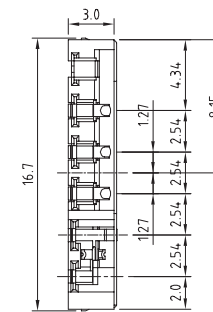
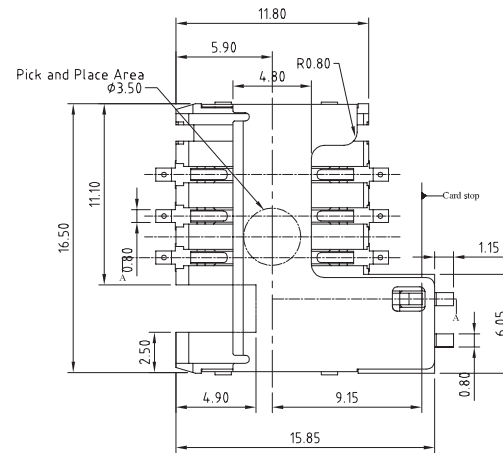
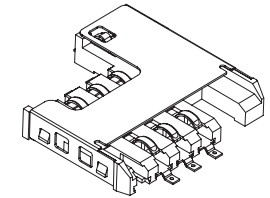
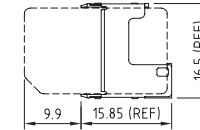
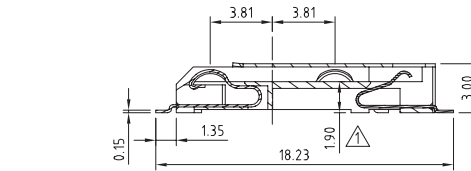

RECOMMENDED PCB LAYOUT

HOW TO ORDER

C H 0 3 - A B 0 6 0 - 0 B R

NO. OF CONTACTS

PACKAGING OPTIONS
R = REEL
(700PCS/REEL)

REV. DATE & DRN
10 25/09/05-NYW RELEASE
11 27/09/06-NYW
12 25/09/06-NYW
13 25/09/06-NYW
14 25/09/06-NYW
15 25/09/06-NYW
16 25/09/06-NYW
17 25/09/06-NYW
18 25/09/06-NYW
19 25/09/06-NYW
20 25/09/06-NYW
21 25/09/06-NYW
22 25/09/06-NYW
23 25/09/06-NYW
24 25/09/06-NYW
25 25/09/06-NYW
26 25/09/06-NYW
27 25/09/06-NYW
28 25/09/06-NYW
29 25/09/06-NYW
30 25/09/06-NYW
31 25/09/06-NYW
32 25/09/06-NYW
33 25/09/06-NYW
34 25/09/06-NYW
35 25/09/06-NYW
36 25/09/06-NYW
37 25/09/06-NYW
38 25/09/06-NYW
39 25/09/06-NYW
40 25/09/06-NYW
41 25/09/06-NYW
42 25/09/06-NYW
43 25/09/06-NYW
44 25/09/06-NYW
45 25/09/06-NYW
46 25/09/06-NYW
47 25/09/06-NYW
48 25/09/06-NYW
49 25/09/06-NYW
50 25/09/06-NYW
51 25/09/06-NYW
52 25/09/06-NYW
53 25/09/06-NYW
54 25/09/06-NYW
55 25/09/06-NYW
56 25/09/06-NYW
57 25/09/06-NYW
58 25/09/06-NYW
59 25/09/06-NYW
60 25/09/06-NYW
61 25/09/06-NYW
62 25/09/06-NYW
63 25/09/06-NYW
64 25/09/06-NYW
65 25/09/06-NYW
66 25/09/06-NYW
67 25/09/06-NYW
68 25/09/06-NYW
69 25/09/06-NYW
70 25/09/06-NYW
71 25/09/06-NYW
72 25/09/06-NYW
73 25/09/06-NYW
74 25/09/06-NYW
75 25/09/06-NYW
76 25/09/06-NYW
77 25/09/06-NYW
78 25/09/06-NYW
79 25/09/06-NYW
80 25/09/06-NYW
81 25/09/06-NYW
82 25/09/06-NYW
83 25/09/06-NYW
84 25/09/06-NYW
85 25/09/06-NYW
86 25/09/06-NYW
87 25/09/06-NYW
88 25/09/06-NYW
89 25/09/06-NYW
90 25/09/06-NYW
91 25/09/06-NYW
92 25/09/06-NYW
93 25/09/06-NYW
94 25/09/06-NYW
95 25/09/06-NYW
96 25/09/06-NYW
97 25/09/06-NYW
98 25/09/06-NYW
99 25/09/06-NYW
100 25/09/06-NYW

Scale: 3:1	THIRD ANGLE	Unstated Tolerances: 0 Dec Places 1 Dec Places 2 Dec Places 3 Dec Places	Material SEE NOTE
Drawn: NYW			
App'd: XXXX	Title SIM CARD ACCEPTOR	NOT TO SCALE	
Date: 25 OCT '10	Revision: 1.7	Unit: mm	

THIS DRAWING IS CONFIDENTIAL AND MUST NOT BE
COPIED OR DISCLOSED WITHOUT WRITTEN CONSENT

Type: CH03-AB

CH03-AB

Drawing Number:

Sheet 1 of 2

Drawing C and O E