

CH03-BH

CUSTOMER PRODUCT SPECIFICATION SHEET

CH03-BH060-B : SIM CARD HOLDER SMT 6 CONTACTS

RoHS
Compliant

FEATURES

1. GENERAL CHARACTERISTICS

DIMENSIONS: 29.70L x 17.20W x 2.50H mm

OPERATING POSITION: SHAFT UP / DOWN / HORIZONTAL

MOUNTING SYSTEM: SMT TYPE

DURABILITY: 5,000 CYCLES

OPERATION TEMPERATURE: -25°C TO +85°C

2. MECHANICAL CHARACTERISTICS

INSULATION MATERIAL: THERMOPLASTIC, UL 94V-0

CONTACT MATERIAL: PHOSPHOR BRONZE

CONTACT PLATING: GOLD ON CONTACT AREA, TIN ON SOLDER TAIL

3. ELECTRICAL CHARACTERISTICS

CONTACT RESISTANCE: 30M OHMS MAX.

INSULATION RESISTANCE:> 1000M OHMS MIN. / 500V DC

RATED CURRENT: 0.5A MAX.

RATED VOLTAGE: 30V AC

WITHSTANDING DIELECTRIC VOLTAGE: 500V AC R.M.S. FOR 1 MINUTE

4. SOLDERABILITY

MAX. PROCESSING TEMP.: 260°C FOR 10 SEC.

NOTES:

1. ACCEPTABLE SIM CARD SIZE SHOULD MEET GSM 11.11 SPECIFICATION REQUIREMENT.

RECOMMENDED PCB LAYOUT

HOW TO ORDER

C H 0 3

-

B H 0 6 0

-

B X X

-

L

NO. OF CONTACTS

WITHOUT SWITCH

WITH OR WITHOUT LOCATING PEG
A = WITH
B = WITHOUT

PACKAGING OPTIONS
T = TRAY
R = REEL

| | | | | | | |
|--|-----------------|-------------|--|----------------------|---|--------------------|
| REV. DATE & DRN | Scale: 2:1 | THIRD ANGLE | Unstated Tolerances: 0 Dec Places 1 Dec Places 2 Dec Places 3 Dec Places | Material SEE NOTE | | Type: CH03-BH |
| 10 01/07/03 - NYW RELEASE | Drawn: NYW | | | | | CH03-BH060-B |
| 11 12/11/04 - NYW DRAWING MODIFICATION | App'd: XXXX | | Title SIM CARD ACCEPTOR | NOT TO SCALE | | Drawing Number: |
| 12 04/02/05 - NYW APPEND LAYOUT DIMENSION | Date: 4 JUN '08 | | Revision : 1.7 | Unit: mm | | Sheet 1 of 3 |
| 13 21/03/06 - NYW ADD RHS OPTION | | | | | THIS DRAWING IS CONFIDENTIAL AND MUST NOT BE COPIED OR DISCLOSED WITHOUT WRITTEN CONSENT | Drawing E and O E |
| 14 14/07/06 - NYW REMOVE NON-ROHS VERSION | | | | | | |
| 15 29/05/07 - NYW ADD NOTES 1 | | | | | | |
| 16 04/06/08 - NYW ADD ELECTRICAL SPEC | | | | | | |
| 17 28/04/09 - CHC PACKAGING DRAWING ADDED | | | | | | |

CH03-BH0X0-XXR-L - REEL PACKAGING DRAWING

SPECIFICATIONS

Reel Size: 330×44.5mm

PE Bag Size: 0.08×700×630mm

Carton Size: 346×346×330mm

QTY: 650Pcs/Reel

RoHS Compliant

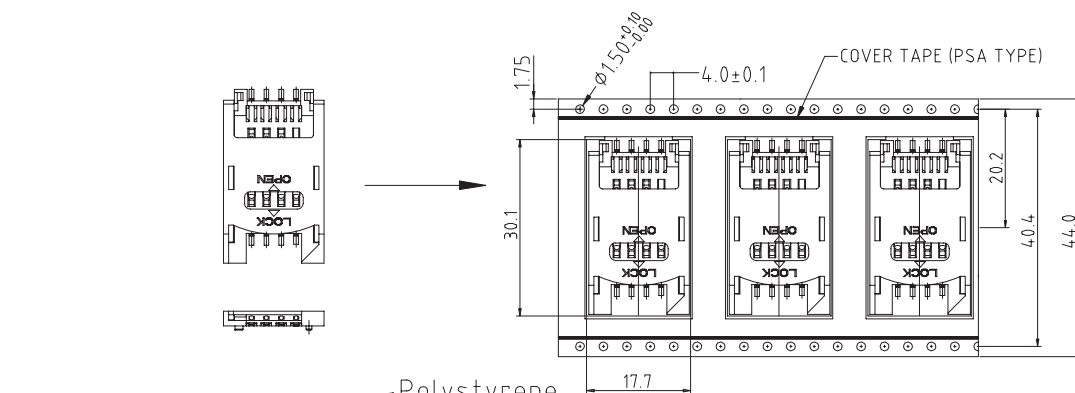

Packing Material Description

Polystyrene

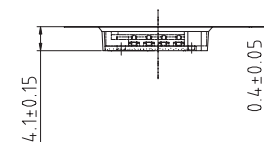
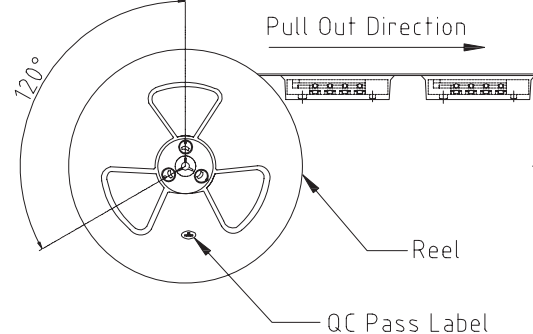

PE Bag Plastic Reel for Embossed Tape

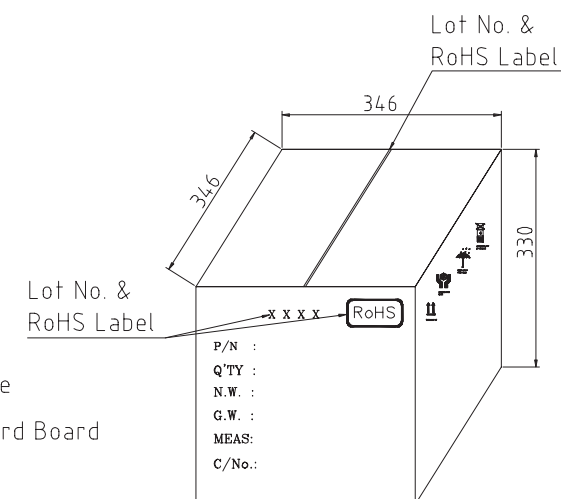
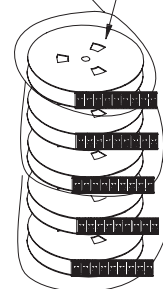

Note:

- 1 REEL=650 PCS
- 1 BOX=6 REEL

| | | | | |
|------------------|------------------|-----------------------|-------------------------------|----------------------|
| | THIRD ANGLE | Unstated .X .XX | Tolerances: ±0.20 ±0.10 | Material SEE NOTE |
| Drawn: CHC | | ANGLES | ±1° | |
| App'd: XXX | Title: PACKAGING | NOT TO SCALE | | |
| Date: 03 FEB '09 | Revision: 1.0 | Unit: mm | | |



| |
|-----------------------|
| Type: CH03-BH |
| CH03-BH0X0-XXR-L |
| Drawing Number: |
| Sheet 2 of 3 |
| Drawing (C) E and O E |

CH03-BH0X0-XXT-L - TRAY PACKAGING DRAWING

PACKING CONDITION

TRAY×10 (110PCS/TRAY)

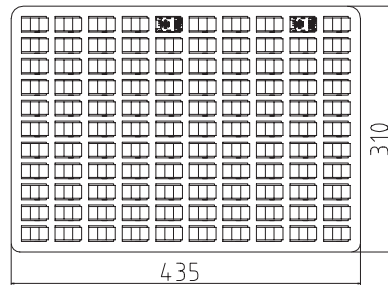

| Q'TY/PCS | | |
|-----------|-----------|------|
| OUTER BOX | INNER BOX | TRAY |
| 5500 | 1100 | 110 |

INNER BOX×5 (1100PCS/BOX)

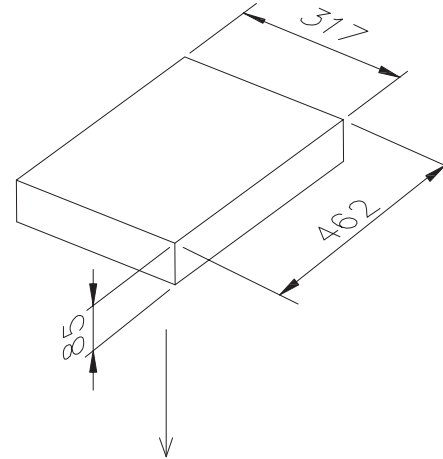

OUTER BOX×1 (5500PCS)

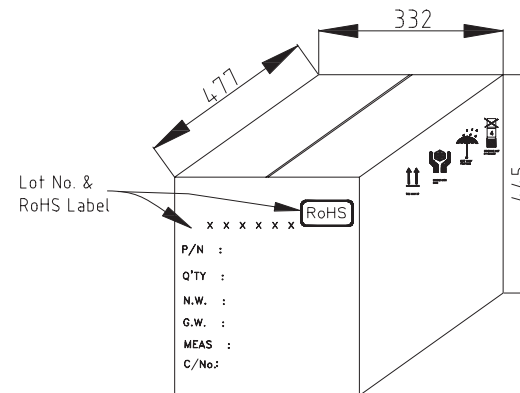

| Drawn: CHC | THIRD ANGLE | Unstated .X .XX | Tolerances: ±0.20 ±0.10 | Material SEE NOTE |
|------------------|------------------|-----------------------|-------------------------------|----------------------|
| | | ANGLES | ±1° | |
| App'd: XXX | Title: PACKAGING | | NOT TO SCALE | |
| Date: 03 FEB '09 | Revision: 1.0 | | Unit: mm | |